

2022

CKD101 L 25 x P 50 x H 78,5

Base a terra - 1 ANTA (Specificare se dx o sx)

TOP ESCLUSO

Complementi: Specchi linea FLAG, MADRE

Dim. Imballo

Peso **20,1 kg**

Pz. Pallet n° -

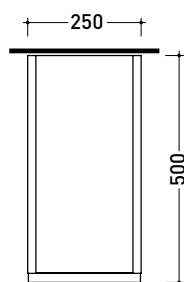

vista zenitale / zenital view

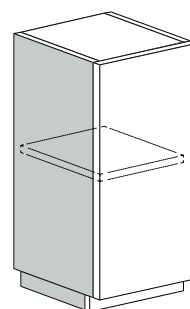

assonometria / axonometry

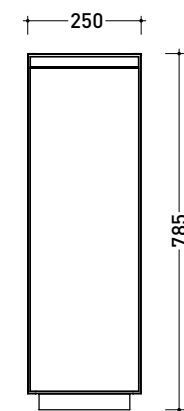

vista frontale / frontal view

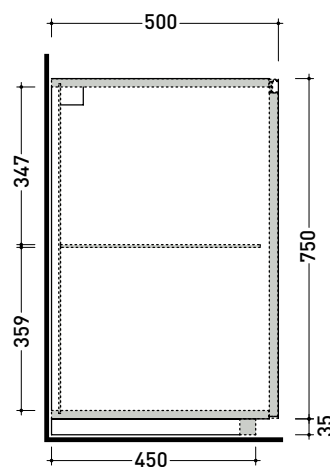

sezio

dimensioni in mm

2022

CKD105 L 35 x P 50 x H 78,5

Base a terra - 1 ANTA (Specificare se dx o sx)

TOP ESCLUSO

Complementi: Specchi linea FLAG, MADRE

Dim. Imballo

Peso **22,7 kg**

Pz. Pallet n° -

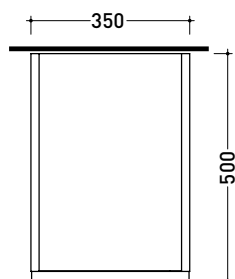

vista zenitale / zenital view

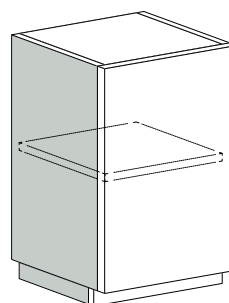

assonometria / axonometry

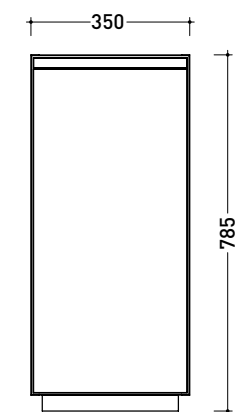

vista frontale / frontal view

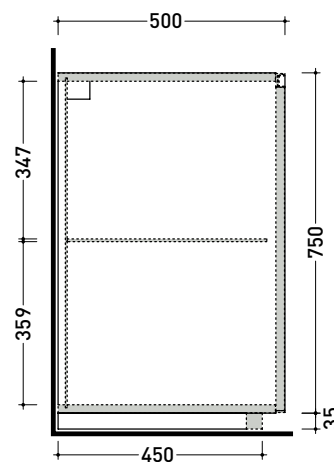

sezione longitudinale / section

dimensioni in mm

2022

CKD109 L 50 x P 50 x H 78,5

Base a terra - 2 ANTE

TOP ESCLUSO

Complementi: Specchi linea FLAG, MADRE

Dim. Imballo

Peso **25,2 kg**

Pz. Pallet n° -

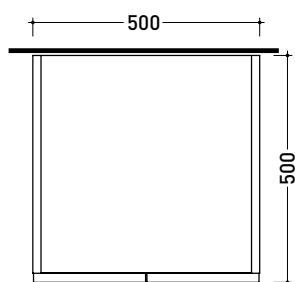

vista zenitale / zenital view

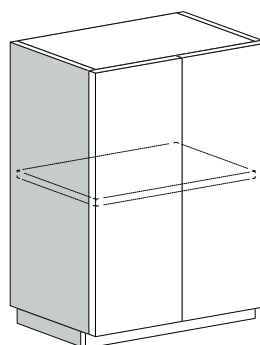

assonometria / axonometry

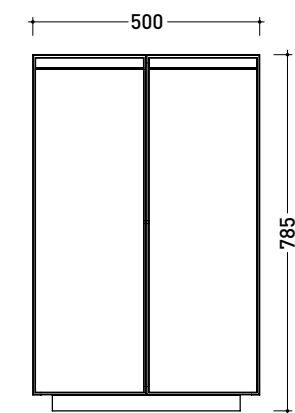

vista frontale / frontal view

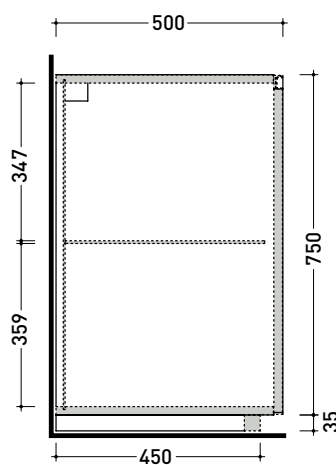

sezione longitudinale / section

dimensioni in mm

2022

CKD115 L 70 x P 50 x H 78,5

Base a terra - 2 ANTE

TOP ESCLUSO

Complementi: Specchi linea FLAG, MADRE

Dim. Imballo

Peso **29,9 kg**

Pz. Pallet n° -

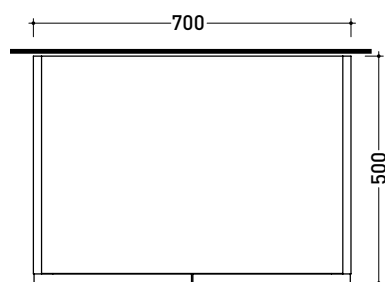

vista zenitale / zenital view

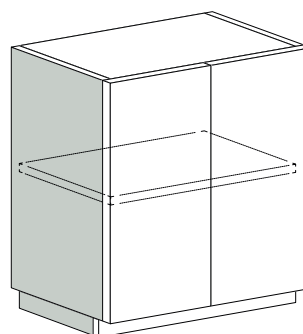

assonometria / axonometry

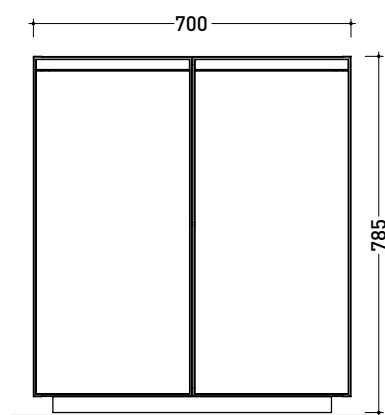

vista frontale / frontal view

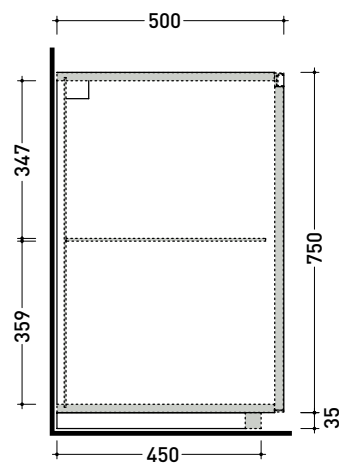

sezione longitudinale / section

dimensioni in mm

2022

CKD173 L 25 x P 50 x H 78,5

Base a terra - 2 CASSETTI

TOP ESCLUSO

Complementi: Specchi linea FLAG, MADRE

Dim. Imballo

Peso **28,9 kg**

Pz. Pallet n° -

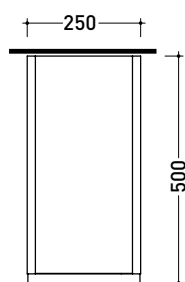

vista zenitale / zenital view

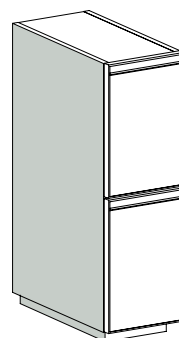

assonometria / axonometry

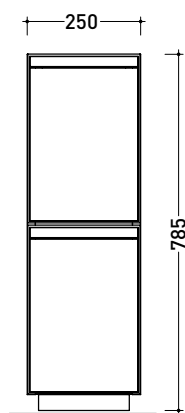

vista frontale / frontal view

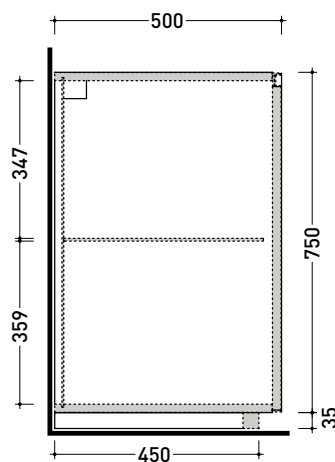

sezione longitudinale / section

dimensioni in mm

2022

CKD170 L 35 x P 50 x H 78,5

Base a terra - 2 CASSETTI

TOP ESCLUSO

Complementi: Specchi linea FLAG, MADRE

Dim. Imballo

Peso **31,4 kg**

Pz. Pallet n° -

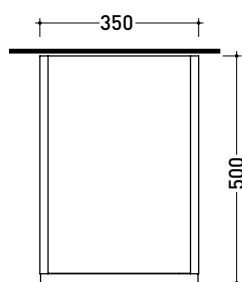

vista zenitale / zenital view

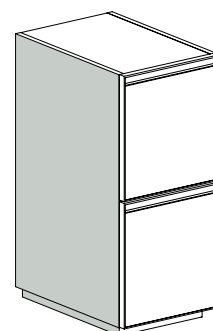

assonometria / axonometry

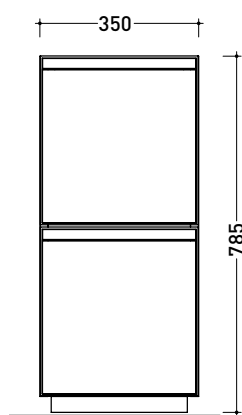

vista frontale / frontal view

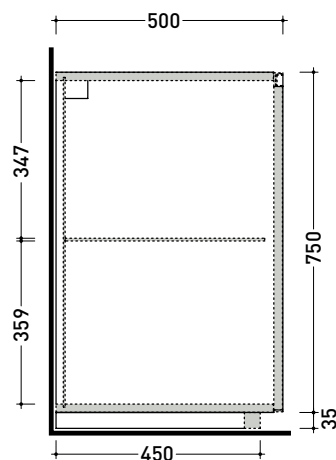

sezione longitudinale / section

dimensioni in mm

2022

CKD152 L50 x P 50 x H 78,5

Base a terra - 2 CASSETTI

TOP ESCLUSO

Complementi: Specchi linea FLAG, MADRE

Dim. Imballo

Peso **35,8 kg**

Pz. Pallet n° -

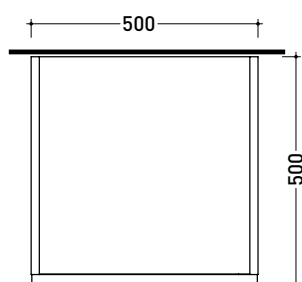

vista zenitale / zenital view

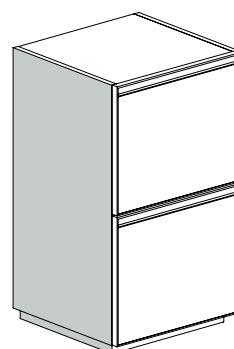

assonometria / axonometry

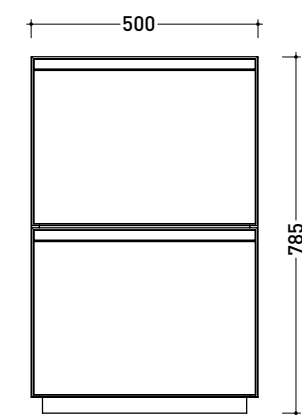

vista frontale / frontal view

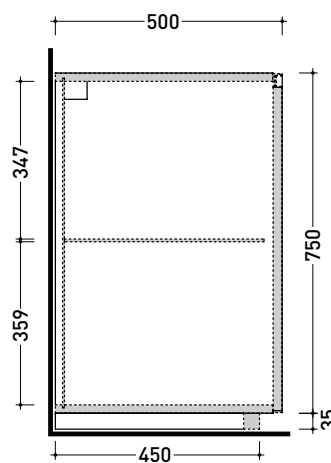

sezione longitudinale / section

dimensioni in mm

2022

CKD158 L 105 x P 50 x H 78,5

Base a terra - 2 CASSETTI

TOP ESCLUSO

Complementi: Specchi linea FLAG, MADRE

Dim. Imballo

Peso **41,1 kg**

Pz. Pallet n° -

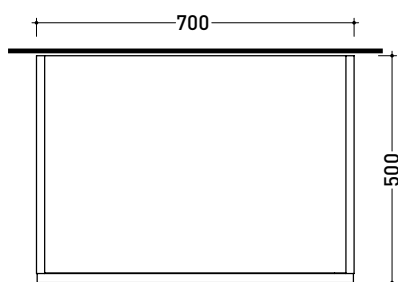

vista zenitale / zenital view

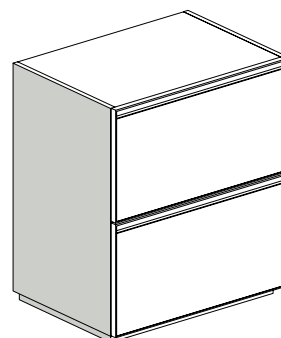

assonometria / axonometry

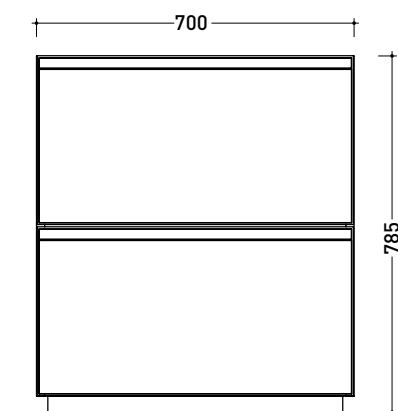

vista frontale / frontal view

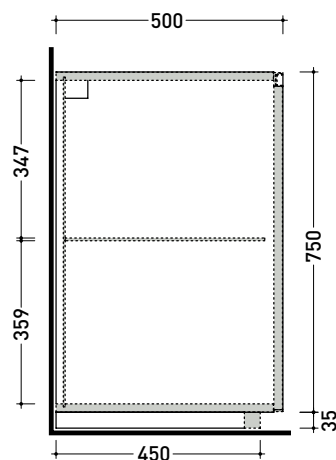

sezione longitudinale / section

dimensioni in mm

2022

CKD164 L 85 x P 50 x H 78,5

Base a terra - 2 CASSETTI

TOP ESCLUSO

Complementi: Specchi linea FLAG, MADRE

Dim. Imballo

Peso **45 kg**

Pz. Pallet n° -

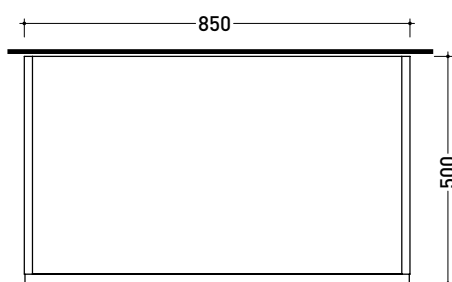

vista zenitale / zenital view

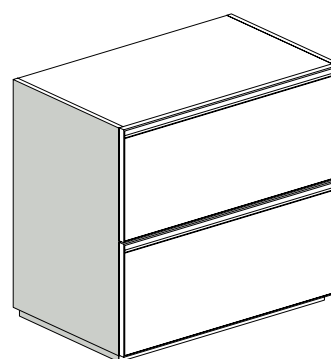

assonometria / axonometry

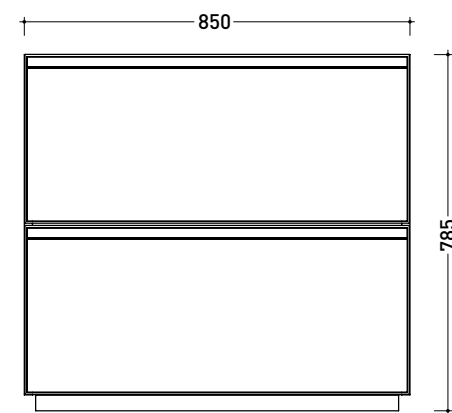

vista frontale / frontal view

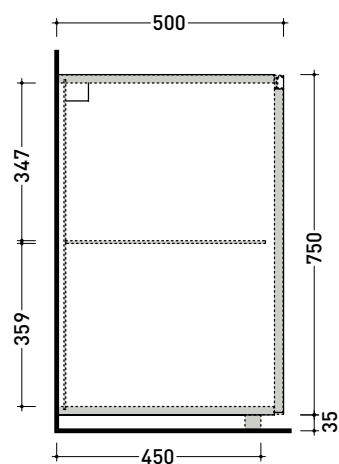

sezione longitudinale / section

dimensioni in mm

2022

CKD401 L 25 x P 50 x H 50

Base sospesa - 1 ANTA (Specificare se dx o sx)

TOP ESCLUSO

Complementi: Specchi linea FLAG, MADRE

Dim. Imballo

Peso 16,3 kg

Pz. Pallet n° -

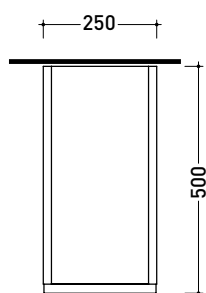

vista zenitale / zenital view

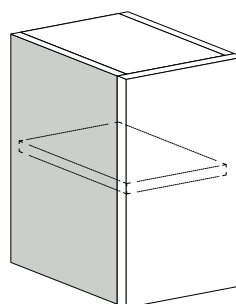

assonometria / axonometry

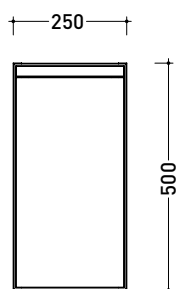

vista frontale / frontal view

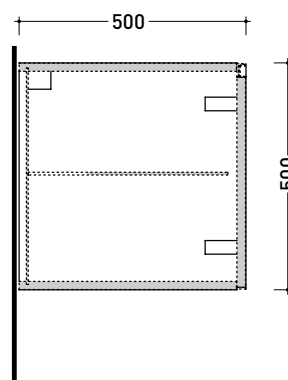

sezione longitudinale / section

dimensioni in mm

CKD407 L 35 x P 50 x H 50

Base sospesa - 1 ANTA (Specificare se dx o sx)

TOP ESCLUSO

Complementi: Specchi linea FLAG, MADRE

Dim. Imballo

Peso 17,8 kg

Pz. Pallet n° -

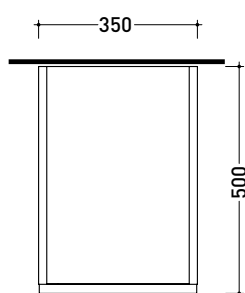

vista zenitale / zenital view

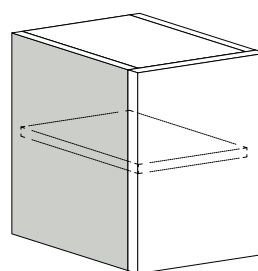

assonometria / axonometry

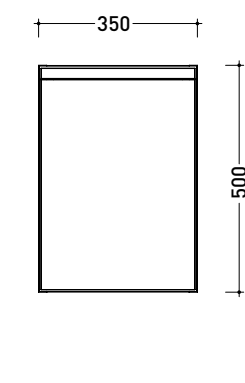

vista frontale / frontal view

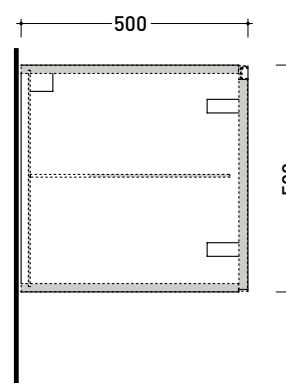

sezione longitudinale / section

dimensioni in mm

2022

CKD413 L 50 x P 50 x H 50

Base sospesa - 2 ANTE

TOP ESCLUSO

Complementi: Specchi linea FLAG, MADRE

Dim. Imballo

Peso **20,4 kg**

Pz. Pallet n° -

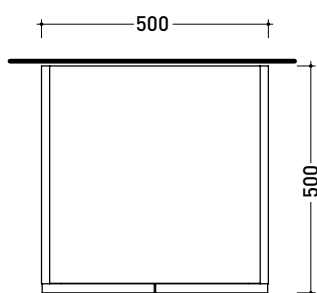

vista zenitale / zenital view

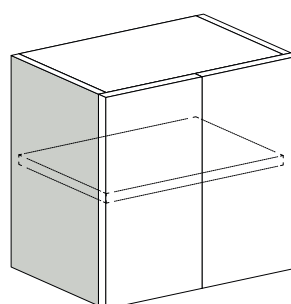

assonometria / axonometry

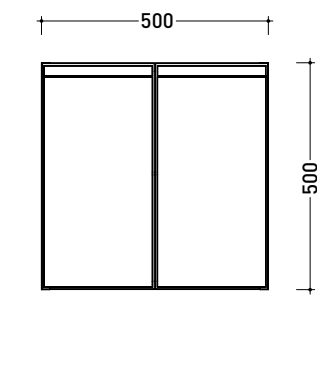

vista frontale / frontal view

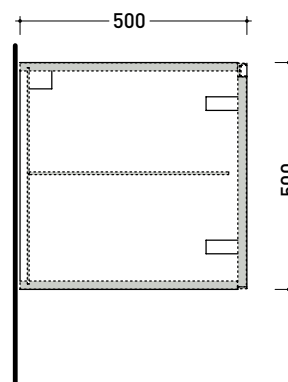

sezione longitudinale / section

dimensioni in mm

2022

CKD421 L70 x P 50 x H 50

Base sospesa - 2 ANTE

TOP ESCLUSO

Complementi: Specchi linea FLAG, MADRE

Dim. Imballo

Peso **23,5 kg**

Pz. Pallet n° -

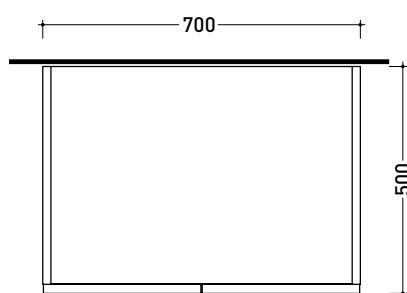

vista zenitale / zenital view

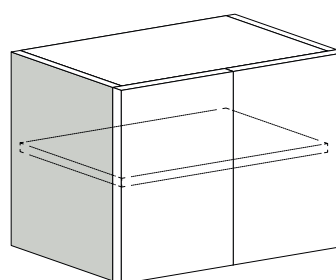

assonometria / axonometry

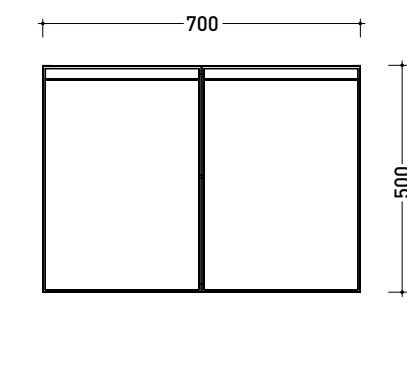

vista frontale / frontal view

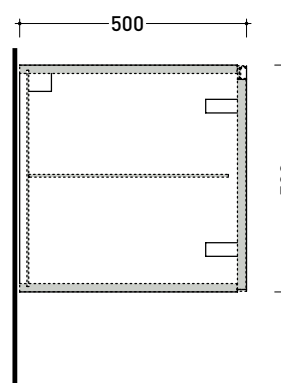

sezione longitudinale / section

dimensioni in mm

2022

CKD497 L 85 x P 50 x H 50

Base sospesa - 2 ANTE

TOP ESCLUSO

Complementi: Specchi linea FLAG, MADRE

Dim. Imballo

Peso **25,4 kg**

Pz. Pallet n° -

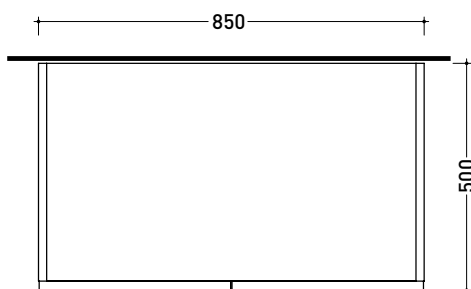

vista zenitale / zenital view

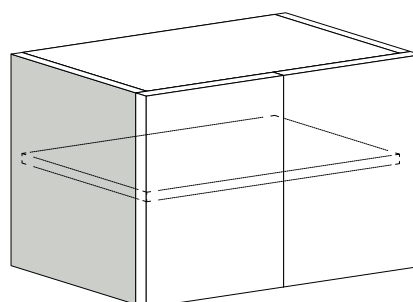

assonometria / axonometry

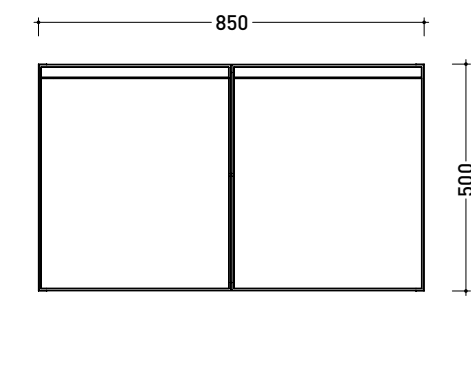

vista frontale / frontal view

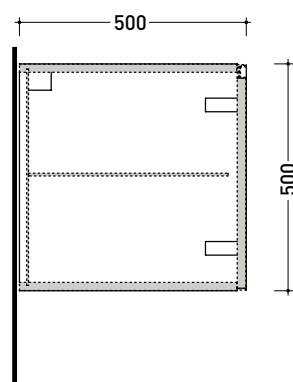

sezione longitudinale / section

dimensioni in mm

2022

CKD585 L 95 x P 50 x H 50

Base sospesa - 2 ANTE

TOP ESCLUSO

Complementi: Specchi linea FLAG, MADRE

Dim. Imballo

Peso 35,7 kg

Pz. Pallet n° -

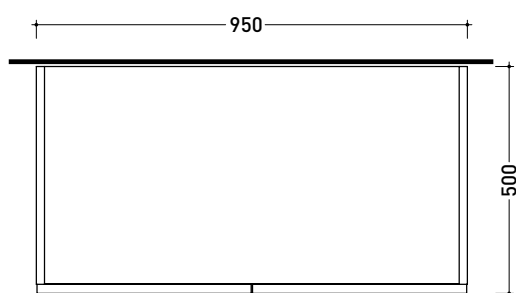

vista zenitale / zenital view

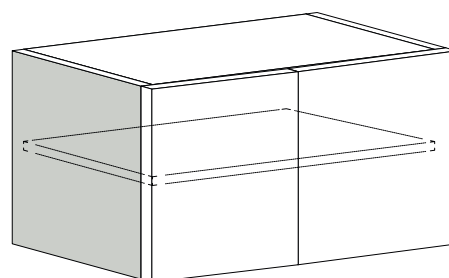

assonometria / axonometry

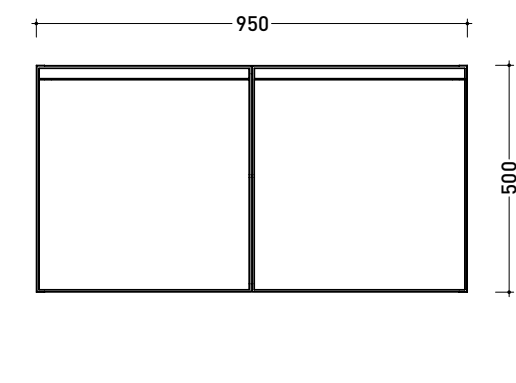

vista frontale / frontal view

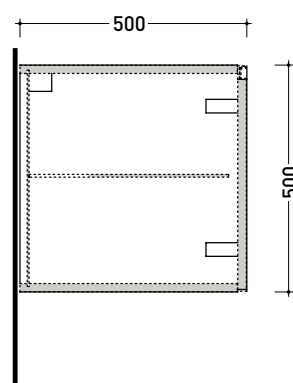

sezione longitudinale / section

dimensioni in mm

2022

CKD461 L 35 x P 50 x H 50

Base sospesa H50 - 1 CASSETTO (+1 INTERNO)

TOP ESCLUSO

Complementi: Specchi linea FLAG, MADRE

Dim. Imballo

Peso **21 kg**

Pz. Pallet n° -

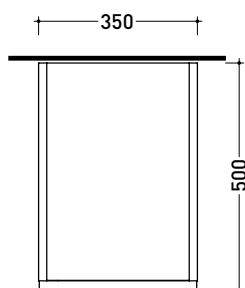

vista zenitale / zenital view

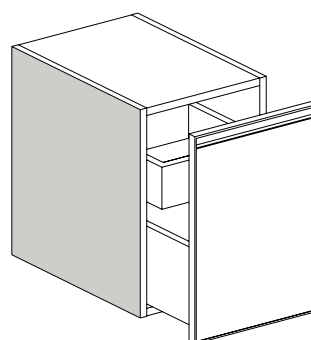

assonometria / axonometry

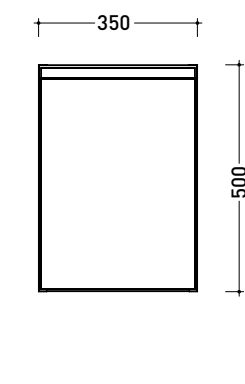

vista frontale / frontal view

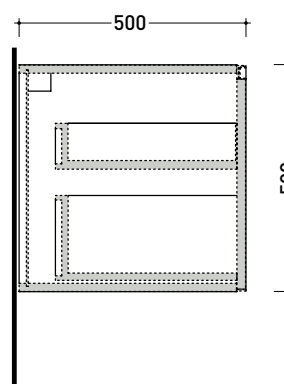

sezione longitudinale / section

dimensioni in mm

CKD467 L 50 x P 50 x H 50

Base sospesa H50 - 1 CASSETTO (+1 INTERNO)

TOP ESCLUSO

Complementi: Specchi linea FLAG, MADRE

Dim. Imballo

Peso **31 kg**

Pz. Pallet n° -

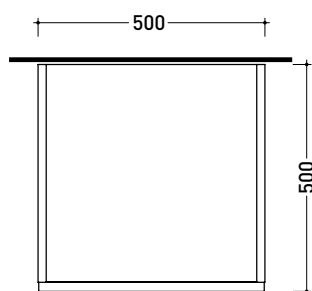

vista zenitale / zenital view

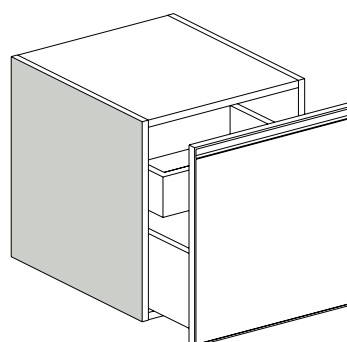

assonometria / axonometry

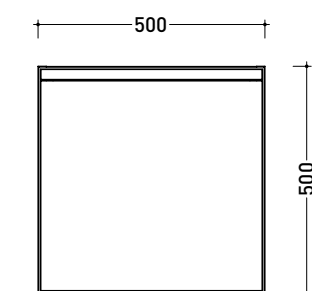

vista frontale / frontal view

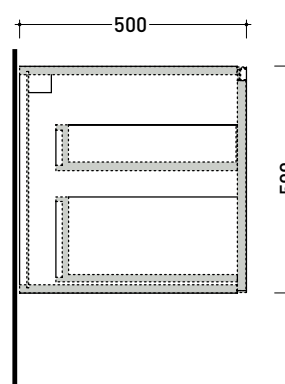

sezione longitudinale / section

dimensioni in mm

2022

CKD621 L 60 x P 50 x H 50

Base sospesa H50 - 1 CASSETTO (+1 INTERNO)

TOP ESCLUSO

Complementi: Specchi linea FLAG, MADRE

Dim. Imballo

Peso **33,6 kg**

Pz. Pallet n° -

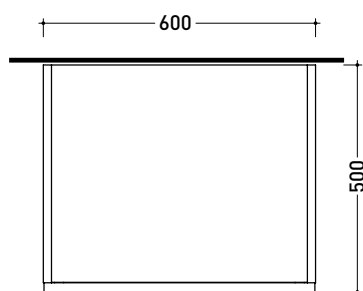

vista zenitale / zenital view

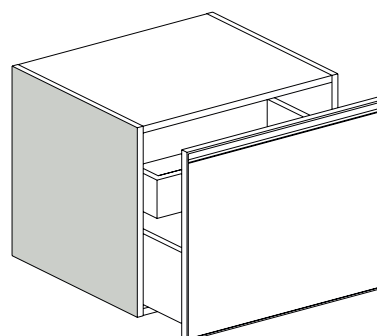

assonometria / axonometry

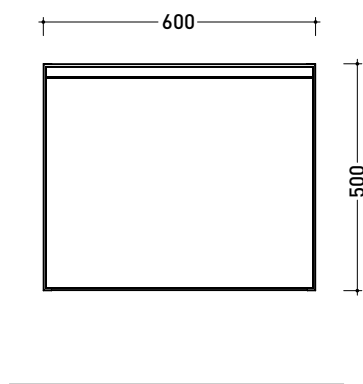

vista frontale / frontal view

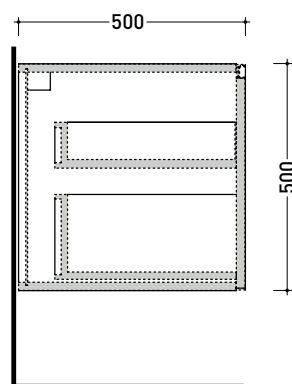

sezione longitudinale / section

dimensioni in mm

2022

CKD473 L 70 x P 50 x H 50

Base sospesa H50 - 1 CASSETTO (+1 INTERNO)

TOP ESCLUSO

Complementi: Specchi linea FLAG, MADRE

Dim. Imballo

Peso **35,1 kg**

Pz. Pallet n° -

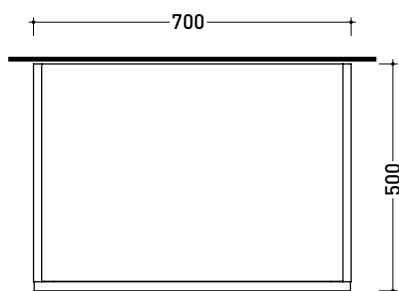

vista zenitale / zenital view

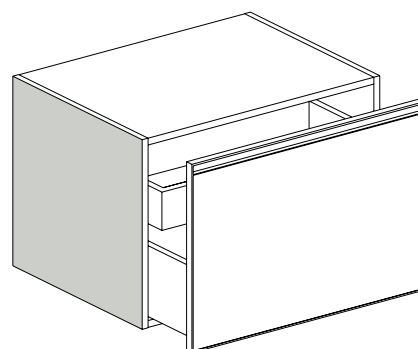

assonometria / axonometry

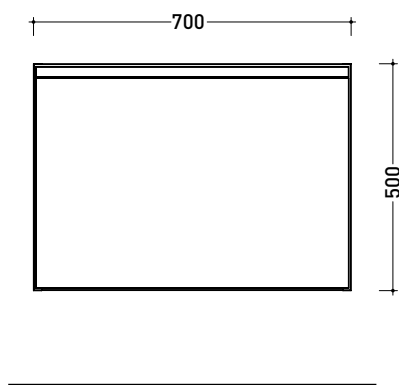

vista frontale / frontal view

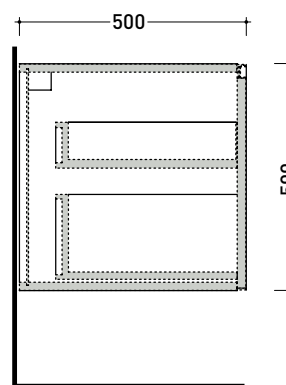

sezione longitudinale / section

dimensioni in mm

2022

CKD487 L 85 x P 50 x H 50

Base sospesa H50 - 1 CASSETTO (+1 INTERNO)
TOP ESCLUSO

Complementi: Specchi linea FLAG, MADRE

Dim. Imballo

Peso **31,6 kg**

Pz. Pallet n° -

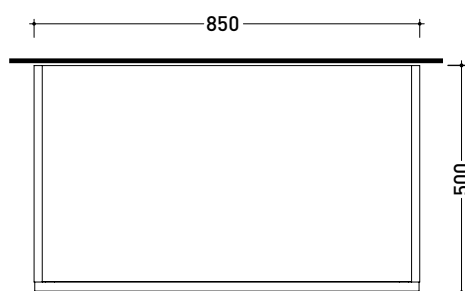
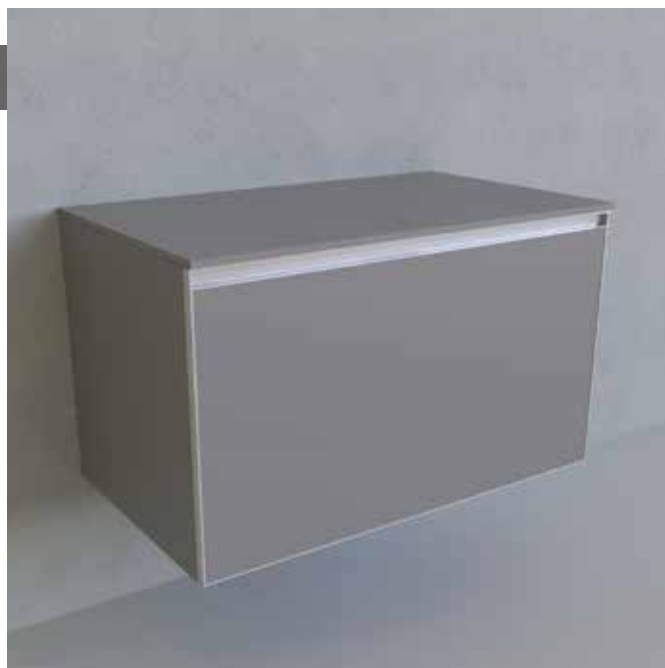

vista zenitale / zenital view

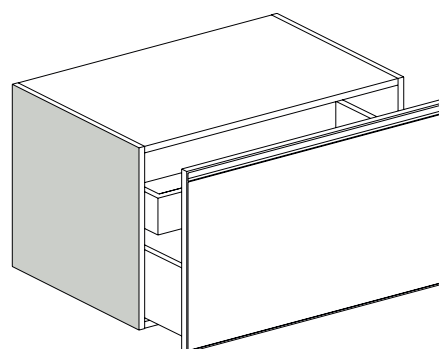

assonometria / axonometry

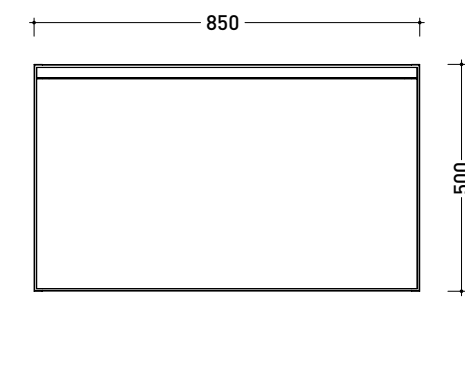

vista frontale / frontal view

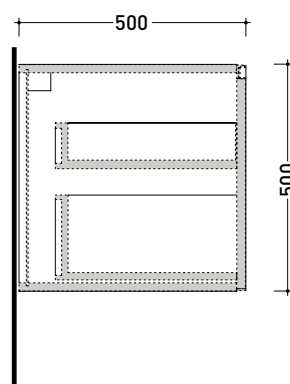

sezione longitudinale / section

dimensioni in mm

2022

CKD490 L 95 x P 50 x H 50

Base sospesa H50 - 1 CASSETTO (+1 INTERNO)

TOP ESCLUSO

Complementi: Specchi linea FLAG, MADRE

Dim. Imballo

Peso 39,7 kg

Pz. Pallet n° -

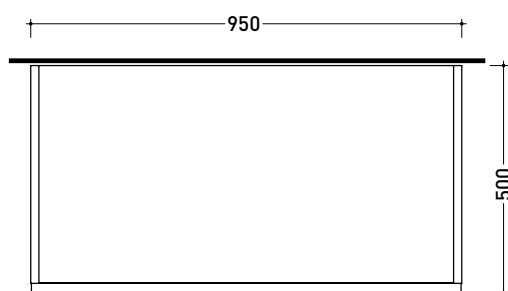

vista zenitale / zenital view

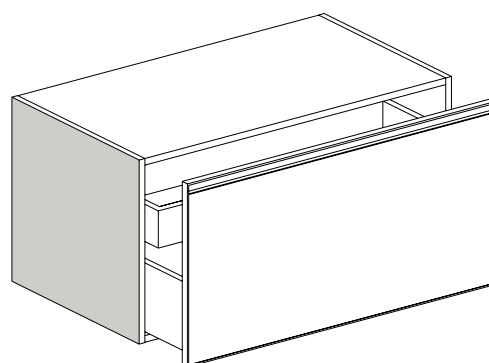

assonometria / axonometry

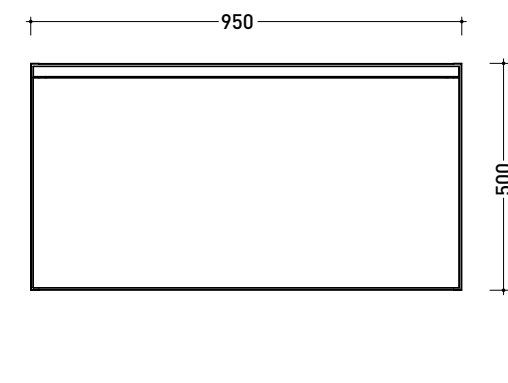

vista frontale / frontal view

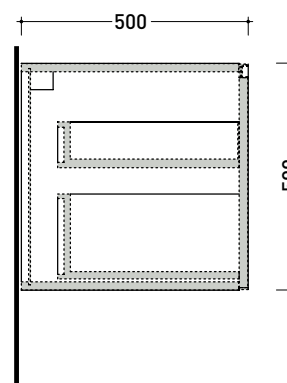

sezione longitudinale / section

dimensioni in mm

2022

CKDE02 L 105 x P 50 x H 50

Base sospesa H50 - 1 CASSETTO (+1 INTERNO)
TOP ESCLUSO

Complementi: Specchi linea FLAG, MADRE

Dim. Imballo

Peso 19,5 kg

Pz. Pallet n° -

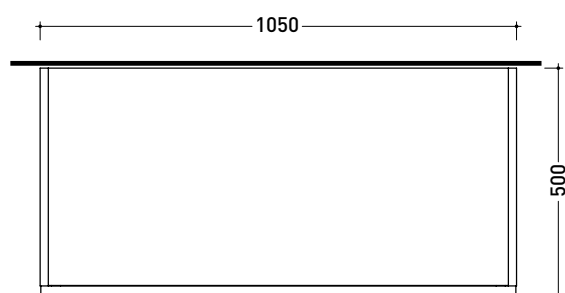

vista zenitale / zenital view

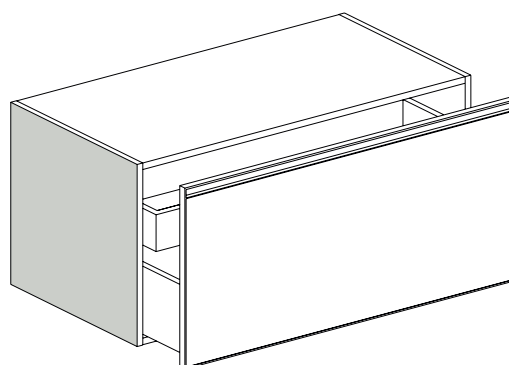

assonometria / axonometry

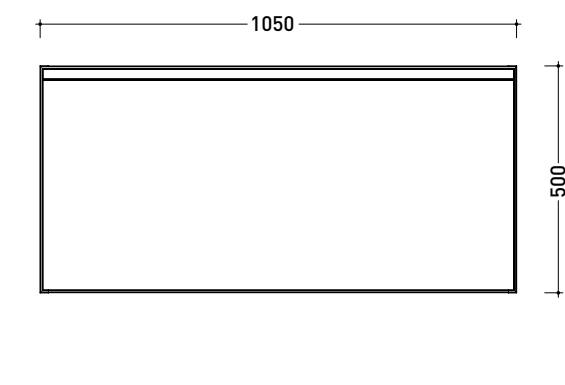

vista frontale / frontal view

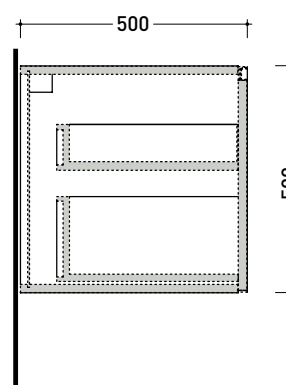

sezione longitudinale / section

dimensioni in mm

2022

CKDE08 L 120 x P 50 x H 50

Base sospesa H50 - 1 CASSETTO (+1 INTERNO)
TOP ESCLUSO

Complementi: Specchi linea FLAG, MADRE

Dim. Imballo

Peso **38,7 kg**

Pz. Pallet n° -

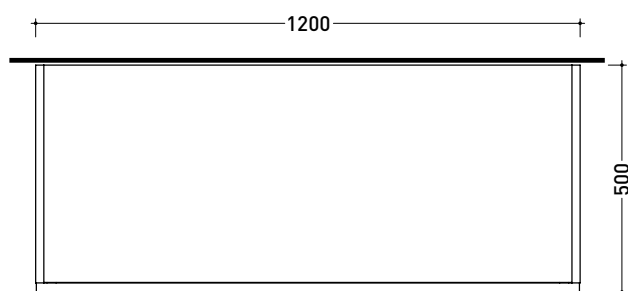

vista zenitale / zenital view

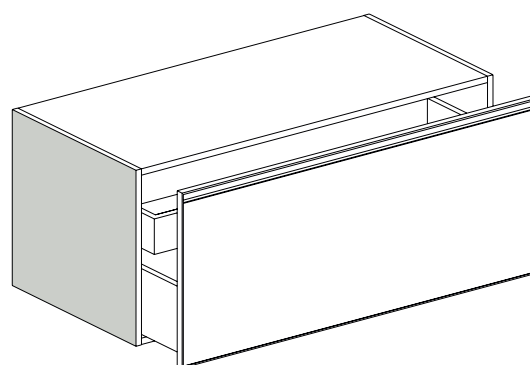

assonometria / axonometry

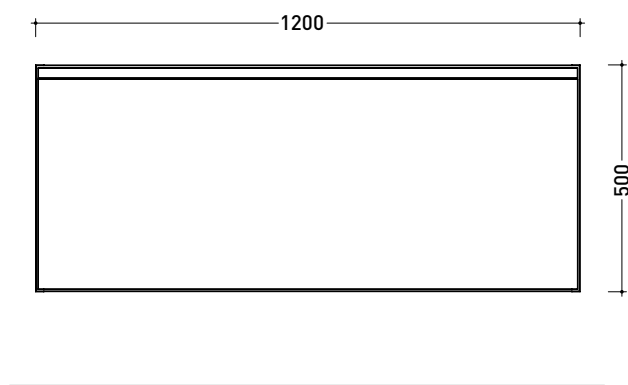

vista frontale / frontal view

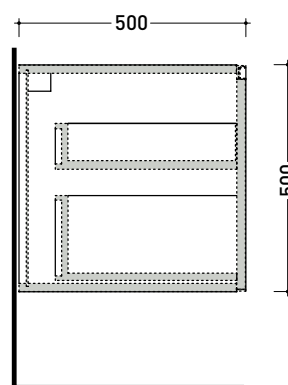

sezione longitudinale / section

dimensioni in mm

2022

CKD405 L 25 x P 50 x H 50

Base sospesa H50 - 2 CASSETTI

TOP ESCLUSO

Complementi: Specchi linea FLAG, MADRE

Dim. Imballo

Peso 19,6 kg

Pz. Pallet n° -

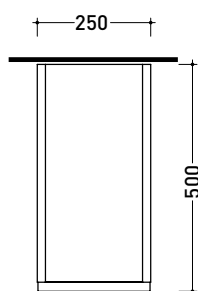

vista zenitale / zenital view

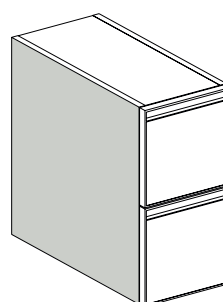

assonometria / axonometry

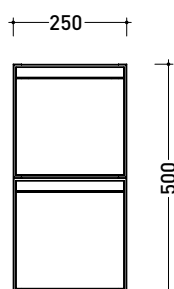

vista frontale / frontal view

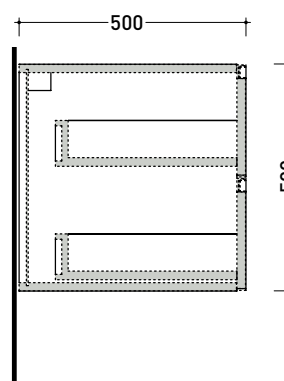

sezione longitudinale / section

dimensioni in mm

2022

CKD411 L 35 x P 50 x H 50

Base sospesa H50 - 2 CASSETTI

TOP ESCLUSO

Complementi: Specchi linea FLAG, MADRE

Dim. Imballo

Peso **21 kg**

Pz. Pallet n° -

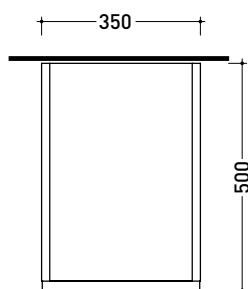

vista zenitale / zenital view

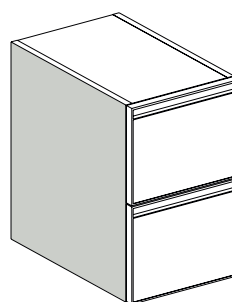

assonometria / axonometry

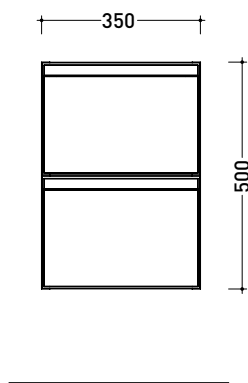

vista frontale / frontal view

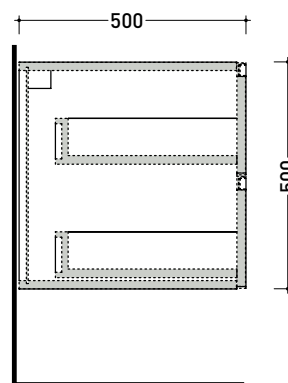

sezione longitudinale / section

dimensioni in mm

2022

CKD417 L50 x P 50 x H 50

Base sospesa H50 - 2 CASSETTI

TOP ESCLUSO

Complementi: Specchi linea FLAG, MADRE

Dim. Imballo

Peso **23,1 kg**

Pz. Pallet n° -

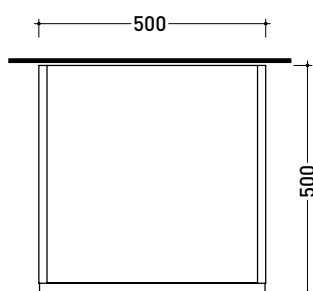

vista zenitale / zenital view

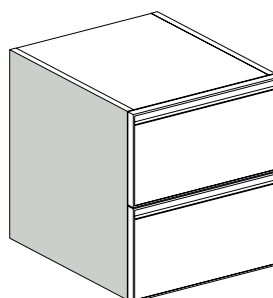

assonometria / axonometry

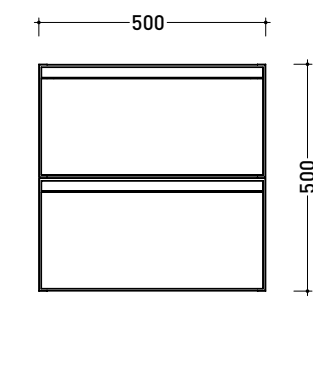

vista frontale / frontal view

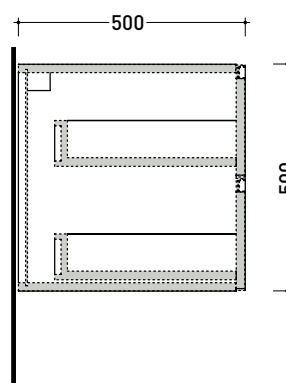

sezione longitudinale / section

dimensioni in mm

2022

CKD425 L 70 x P 50 x H 50

Base sospesa H50 - 2 CASSETTI

TOP ESCLUSO

Complementi: Specchi linea FLAG, MADRE

Dim. Imballo

Peso **26 kg**

Pz. Pallet n° -

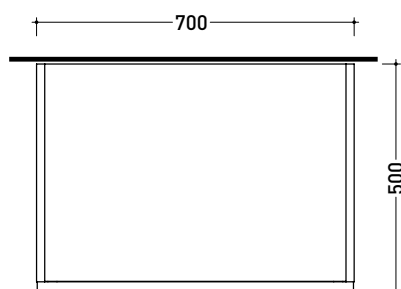

vista zenitale / zenital view

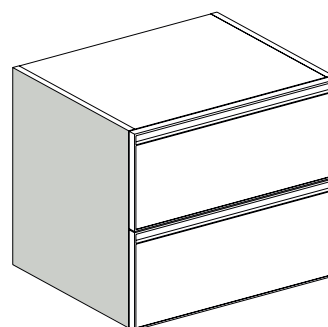

assonometria / axonometry

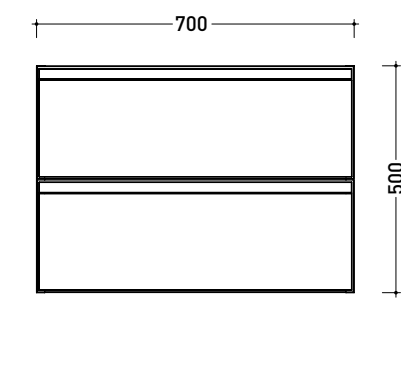

vista frontale / frontal view

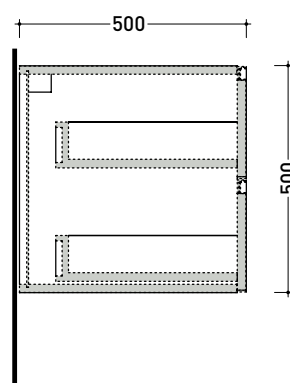

sezione longitudinale / section

dimensioni in mm

2022

CKD429 L 85 x P 50 x H 50

Base sospesa H50 - 2 CASSETTI

TOP ESCLUSO

Complementi: Specchi linea FLAG, MADRE

Dim. Imballo

Peso **28,2 kg**

Pz. Pallet n° -

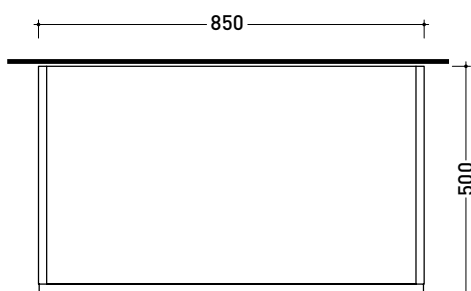
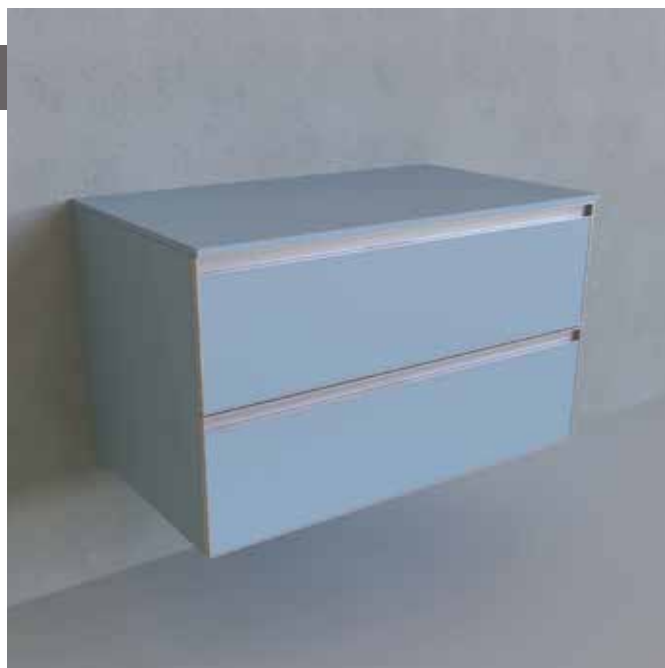

vista zenitale / zenital view

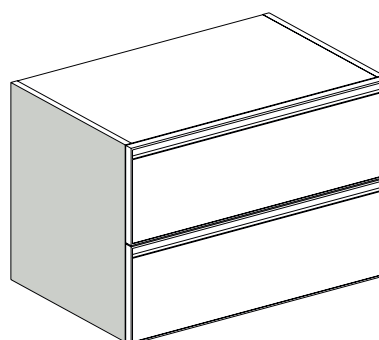

assonometria / axonometry

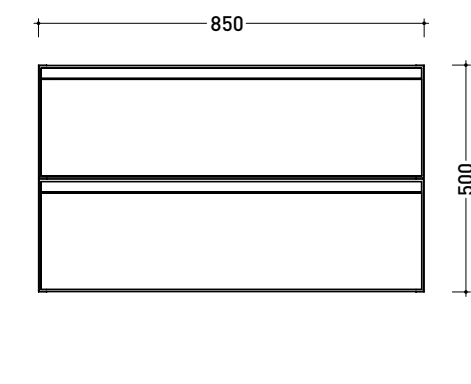

vista frontale / frontal view

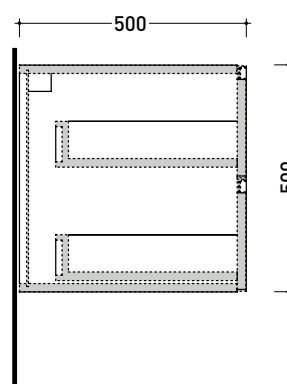

sezione longitudinale / section

dimensioni in mm

2022

CKD433 L 95 x P 50 x H 50

Base sospesa H50 - 2 CASSETTI

TOP ESCLUSO

Complementi: Specchi linea FLAG, MADRE

Dim. Imballo

Peso **29,6 kg**

Pz. Pallet n° -

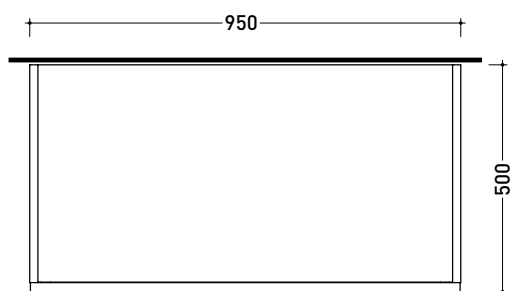

vista zenitale / zenital view

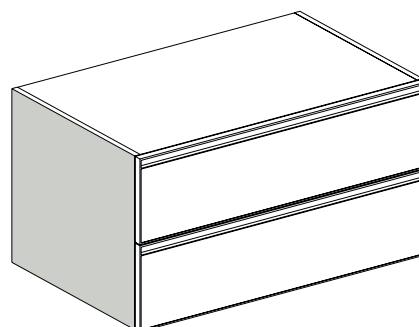

assonometria / axonometry

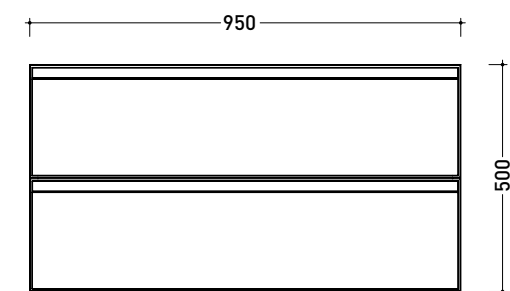

vista frontale / frontal view

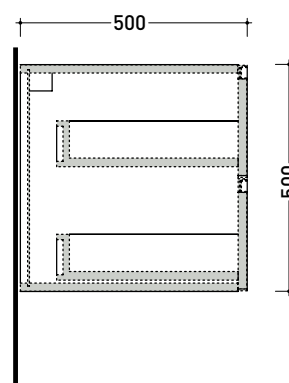

sezione longitudinale / section

dimensioni in mm

2022

CKDE05 L 105 x P 50 x H 50

Base sospesa H50 - 2 CASSETTI

TOP ESCLUSO

Complementi: Specchi linea FLAG, MADRE

Dim. Imballo

Peso 19,5 kg

Pz. Pallet n° -

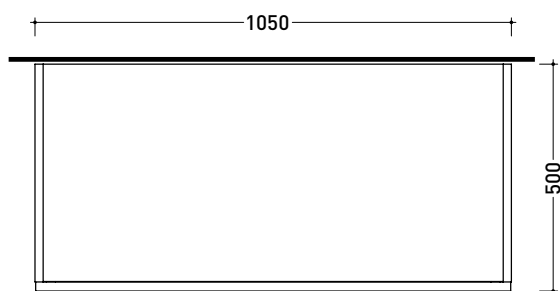

vista zenitale / zenital view

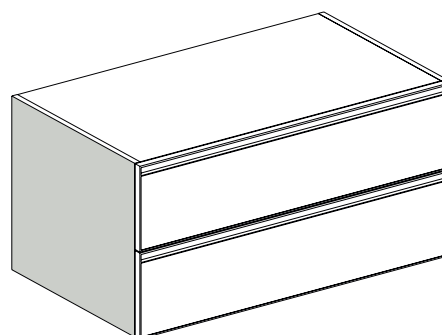

assonometria / axonometry

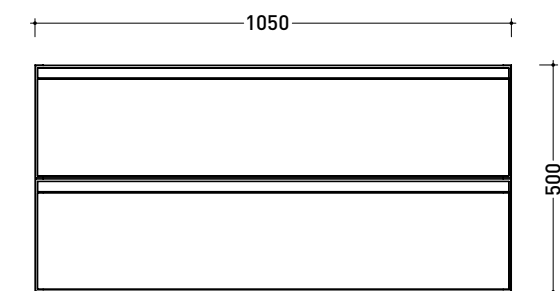

vista frontale / frontal view

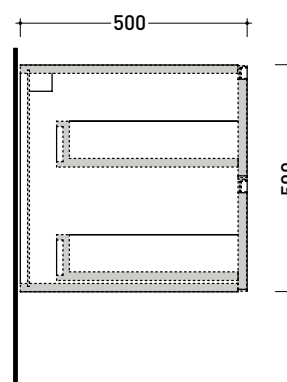

sezione longitudinale / section

dimensioni in mm

2022

CKDE11 L 120 x P 50 x H 50

Base sospesa H50 - 2 CASSETTI

TOP ESCLUSO

Complementi: Specchi linea FLAG, MADRE

Dim. Imballo

Peso **36,7 kg**

Pz. Pallet n° -

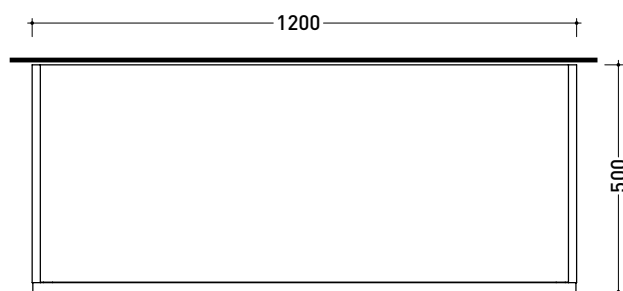
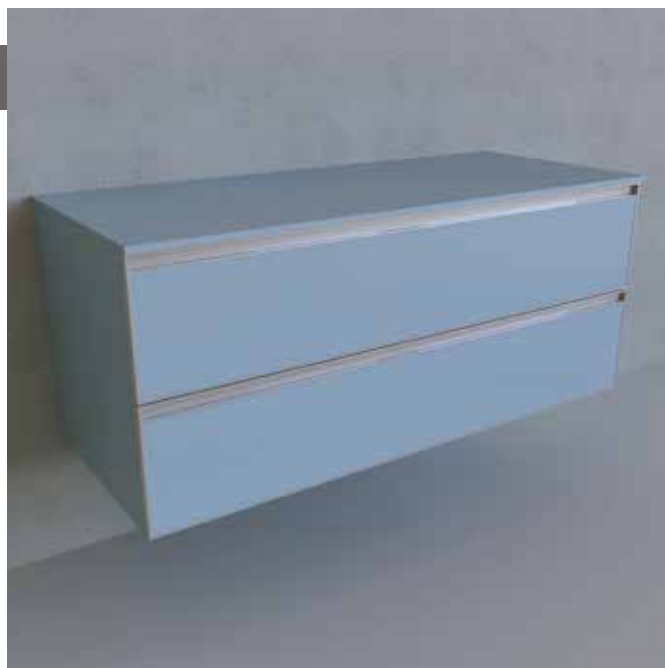

vista zenitale / zenital view

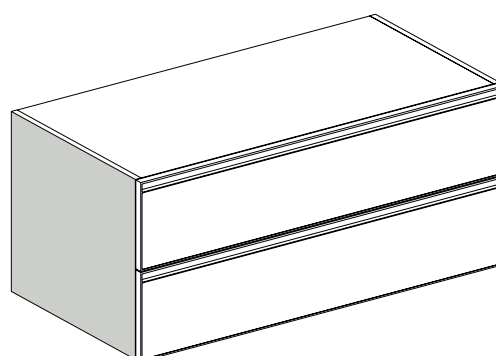

assonometria / axonometry

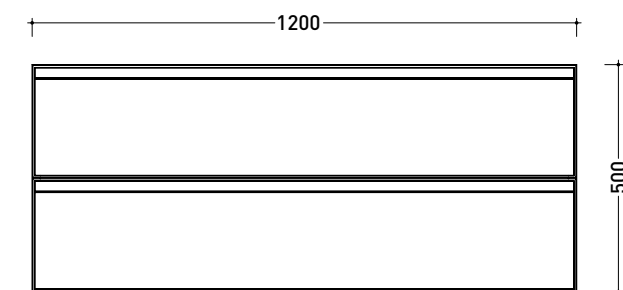

vista frontale / frontal view

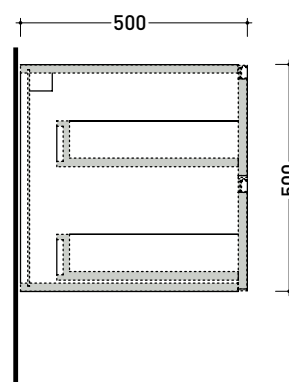

sezione longitudinale / section

dimensioni in mm

2022

CKPR51 L 25 a max 270 x P 51 x H 1,2

Piano di copertura in legno da cm 25 a 270
per BASI prof. 50 cm

ATTENZIONE:

Il piano di copertura va sempre previsto e va ordinato separatamente.



CE

vista zenitale / zenital view

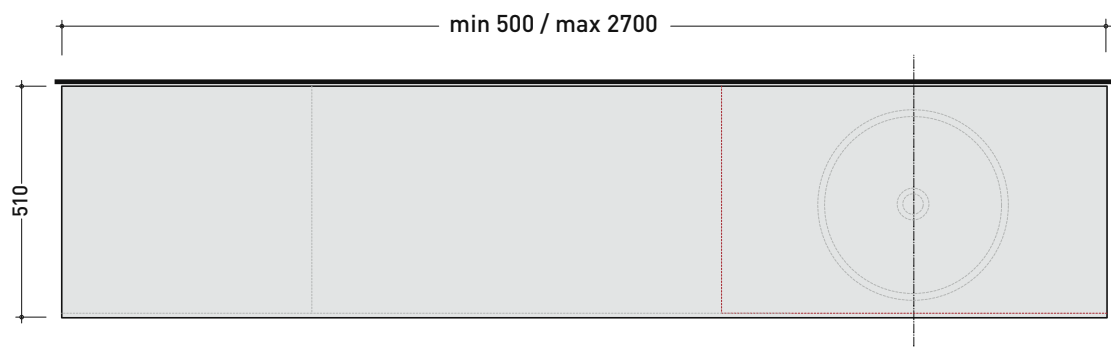

vista frontale / frontal view

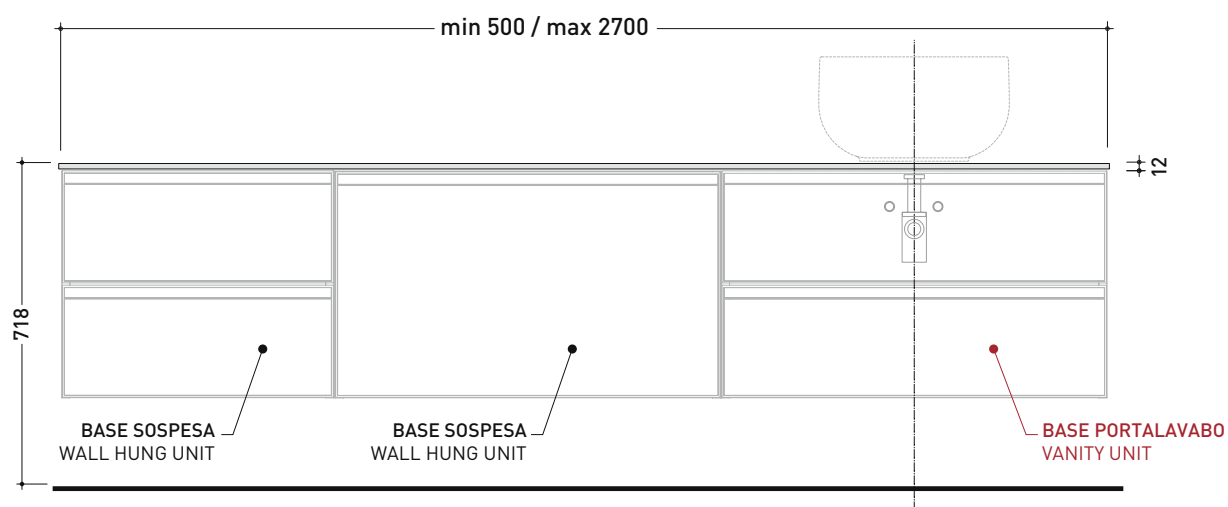

dimensioni in mm

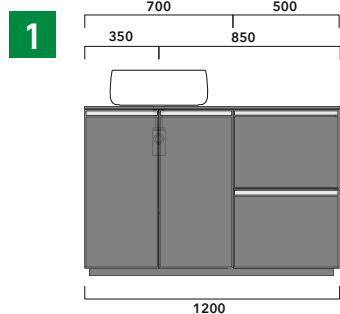

1 I profondità cm 50:
n.1 CKD910 + n.1 CKD152 + CKPR51 cm 120

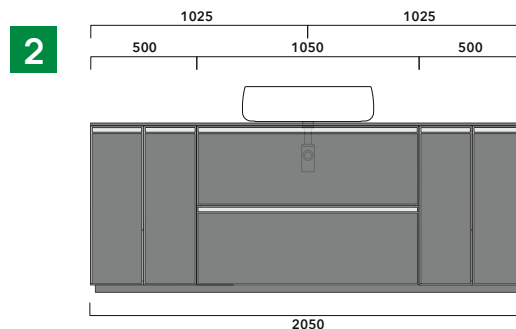

2 I profondità cm 50:
n.2 CKD109 + n.1 CKD754 + CKPR51 cm 205

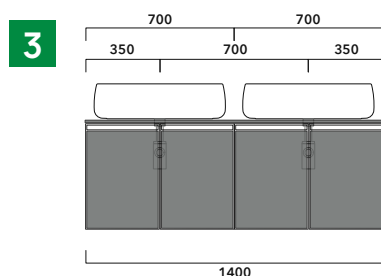

3 I profondità cm 50:
n.2 CKD803 + CKPR51 cm 140

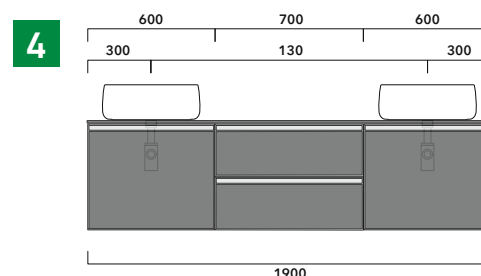

4 I profondità cm 50:
n.1 CKD801 + n. 1 CKD425 + CKPR51 cm 190

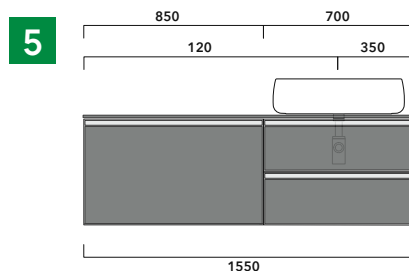

5 I profondità cm 50:
n.1 CKD487 + n.1 CKD809 + CKPR51 cm 155

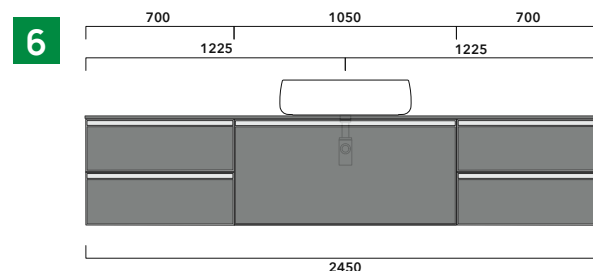

6 I profondità cm 50:
n.2 CKD425 + n.1 CKD893 + CKPR51 cm 245

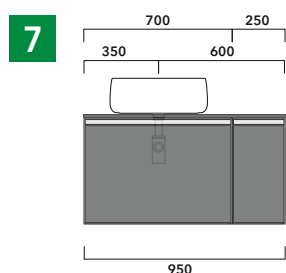

7 I profondità cm 50:
n.1 CKD876 + n. 1 CKD401 + CKPR51 cm 95

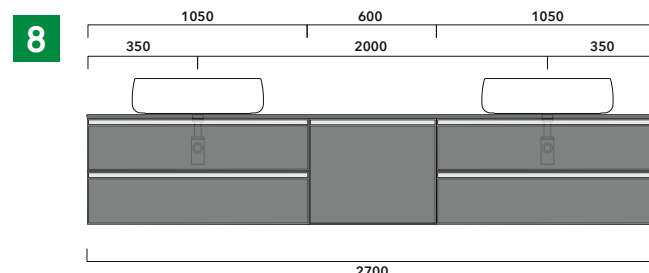

8 I profondità cm 50:
n.2 CKD839 + n. 1 CKD621 + CKPR51 cm 270

➔FLAMINIA. MODULO PER LA REALIZZAZIONE DELLE COMPOSIZIONI MOBILI CUBIKA CUSTOMIZED COMPOSITION FORM FOR CUBIKA UNITS



E' obbligatorio fotocopiare questa pagina, compilarla con cura e allegarla all'ordine.
It is compulsory to photocopy this page, carefully fill in and attach to the order.

»1 DETTAGLI ORDINE / ORDER DETAILS

ordinante - buyer

cliente - client

ordine - order n:

data - date:

ref.:

annotazioni - notes

»2 PROFONDITÀ MOBILE / UNIT DEPTH

É importante consultare il listino prezzi / It's important to consult price list

☐ CM 37

☐ CM 50

»3 DISEGNO / DRAWING

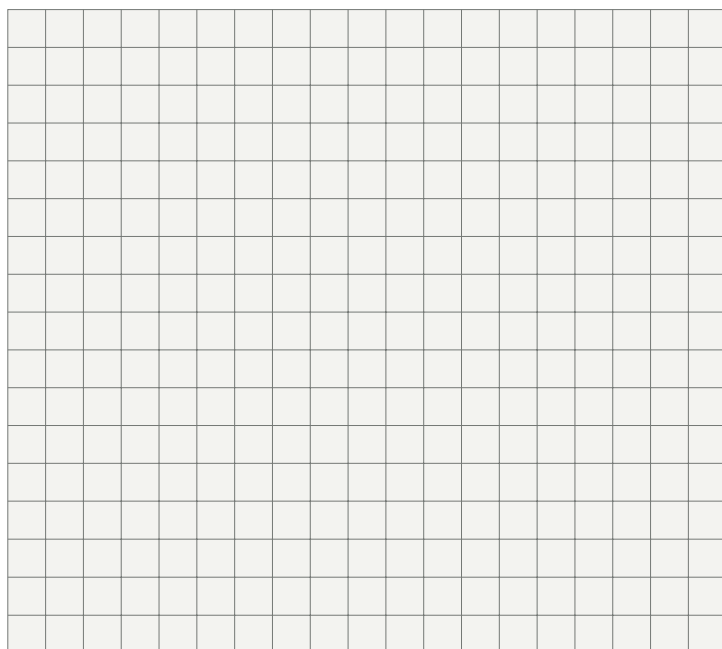

»4 ELENCO ARTICOLI / ARTICLE LIST

É importante consultare il listino prezzi
It's important to consult price list

n. art. dim.

n. art. dim.

n. art. dim.

n. art. dim.

n. art. dim.

n. art. dim.

n. art. dim.

IMPORTANTE: per il mobile con una sola anta
specificare se è cerniera sinistra o destra
IMPORTANT: for cabinet with one door specify
whether it is left or right hinge

»5 LAVABO DA APPOGGIO / COUTERTOP BASIN

☐ FLAMINIA lavabo/basin art. _____

☐ NO FLAMINIA lavabo/basin
(allegare scheda tecnica / enclose a technical drawing)

»6 FINITURA TOP / FINISH TOP

essenze legno / wood:

GRES:

legno laccato opaco / mat lacquered wood:

☐ EUCALIPTO

☐ FOKOS SALE

☐ BIANCO

☐ TAUPE

☐ BORDEAUX

☐ NOCE GRECA

☐ FOKOS TERRA

☐ GREY

☐ CIPRIA

☐ VERDE PALUDE

☐ ROVERE NAT. GRECA

☐ JUTA

☐ ROSA VINTAGE

»6 SCELTA FINITURA / FINISH SELECTION

essenze legno / wood:

GRES:

legno laccato opaco / mat lacquered wood:

☐ EUCALIPTO

☐ FOKOS SALE

☐ BIANCO

☐ TAUPE

☐ BORDEAUX

☐ NOCE GRECA

☐ FOKOS TERRA

☐ GREY

☐ CIPRIA

☐ VERDE PALUDE

☐ ROVERE NAT. GRECA

☐ JUTA

☐ ROSA VINTAGE