

2022

## CKD100 L 25 x P 37 x H 78,5

Base a terra - 1 ANTA (Specificare se dx o sx)

**TOP ESCLUSO**

Complementi: Specchi linea FLAG, MADRE

Dim. Imballo

Peso 17,8 kg

Pz. Pallet n° -

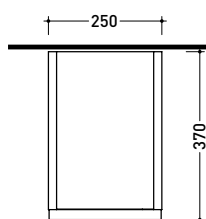

vista zenitale / zenital view

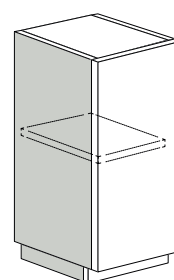

assonometria / axonometry

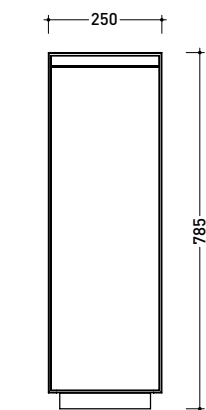

vista frontale / frontal view

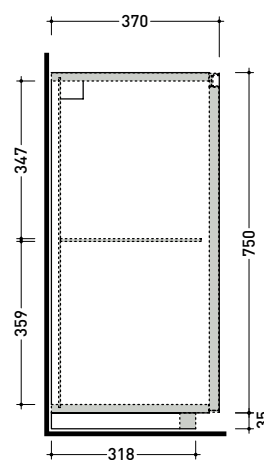

sezione longitudinale / section

dimensioni in mm

2022

## CKD104 L 35 x P 37 x H 78,5

Base a terra - 1 ANTA (Specificare se dx o sx)

**TOP ESCLUSO**

Complementi: Specchi linea FLAG, MADRE

Dim. Imballo

Peso 17,9 kg

Pz. Pallet n° -

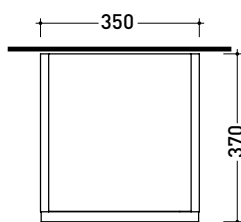

vista zenitale / zenital view

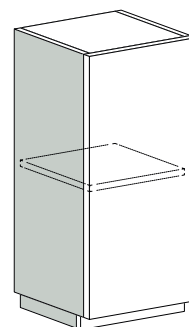

assonometria / axonometry

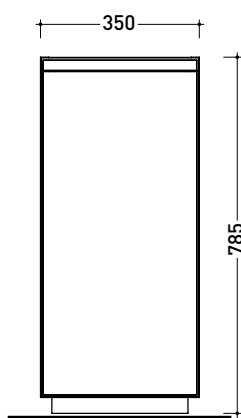

vista frontale / frontal view

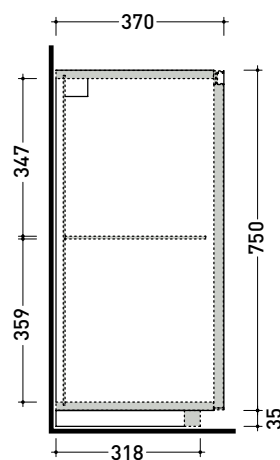

sezione longitudinale / section

dimensioni in mm

2022

## CKD108 L 50 x P 37 x H 78,5

Base a terra - 2 ANTE

**TOP ESCLUSO**

Complementi: Specchi linea FLAG, MADRE

Dim. Imballo

Peso **21,9 kg**

Pz. Pallet n° -

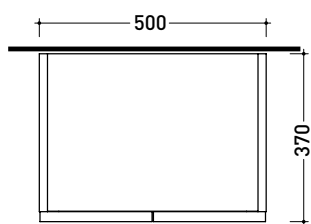

**vista zenitale / zenital view**

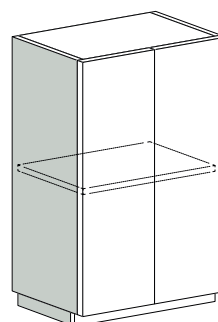

**assonometria / axonometry**

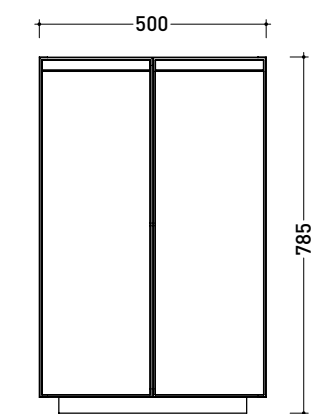

**vista frontale / frontal view**

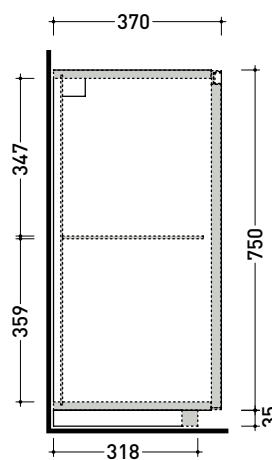

**sezione longitudinale / section**

dimensioni in mm

2022

## CKD114 L70xP37xH78,5

Base a terra - 2 ANTE

**TOP ESCLUSO**

Complementi: Specchi linea FLAG, MADRE

Dim. Imballo

Peso **25,3 kg**

Pz. Pallet n° -

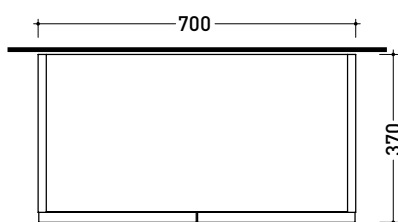

vista zenitale / zenital view

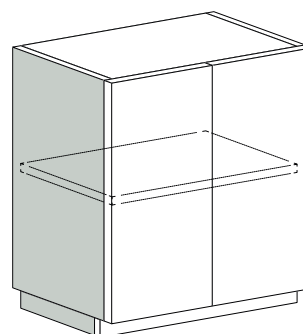

assonometria / axonometry

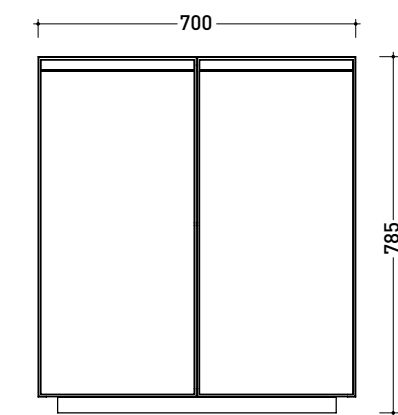

vista frontale / frontal view

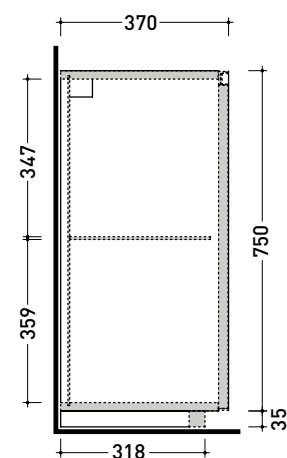

sezione longitudinale / section

dimensioni in mm

2022

## CKD172 L 25 x P 37 x H 78,5

Base a terra - 2 CASSETTI

**TOP ESCLUSO**

Complementi: Specchi linea FLAG, MADRE

Dim. Imballo

Peso **20,5 kg**

Pz. Pallet n° -

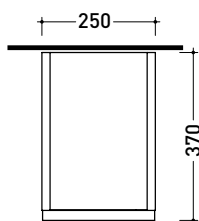

vista zenitale / zenital view

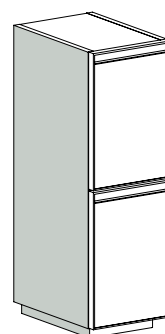

assonometria / axonometry

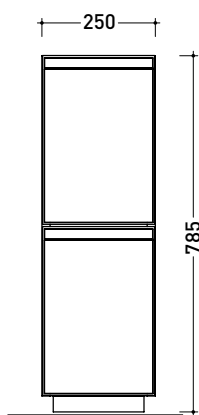

vista frontale / frontal view

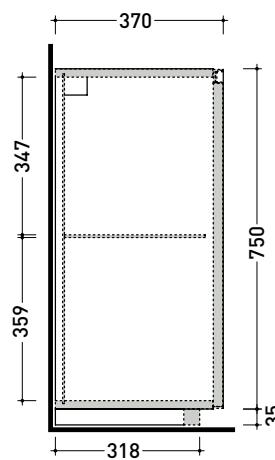

sezione longitudinale / section

dimensioni in mm

2022

## CKD169 L 35 x P 37 x H 78,5

Base a terra - 2 CASSETTI

**TOP ESCLUSO**

Complementi: Specchi linea FLAG, MADRE

Dim. Imballo

Peso **23 kg**

Pz. Pallet n° -

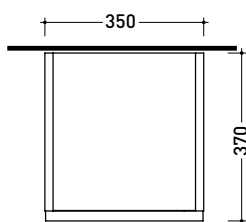

vista zenitale / zenital view

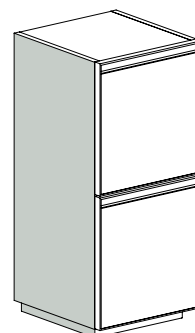

assonometria / axonometry

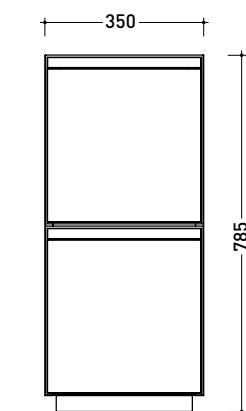

vista frontale / frontal view

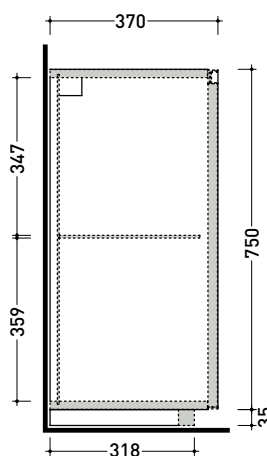

sezione longitudinale / section

dimensioni in mm

2022

## CKD151 L 50 x P 37 x H 78,5

Base a terra - 2 CASSETTI

**TOP ESCLUSO**

Complementi: Specchi linea FLAG, MADRE

Dim. Imballo

Peso **25,1 kg**

Pz. Pallet n° -

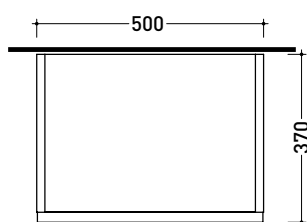

vista zenitale / zenital view

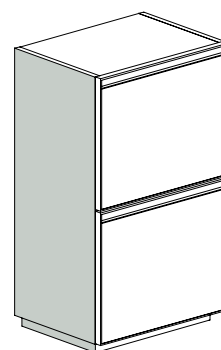

assonometria / axonometry

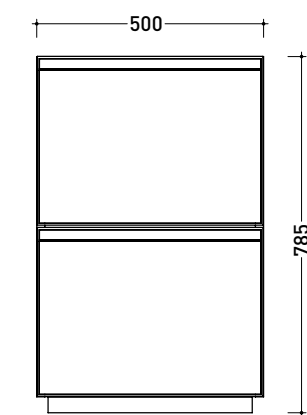

vista frontale / frontal view

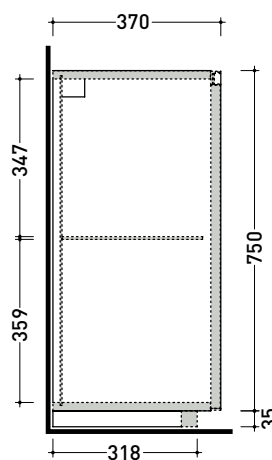

sezione longitudinale / section

dimensioni in mm

2022

## CKD157 L105 x P 37 x H 78,5

Base a terra - 2 CASSETTI

**TOP ESCLUSO**

Complementi: Specchi linea FLAG, MADRE

Dim. Imballo

Peso 29,7 kg

Pz. Pallet n° -

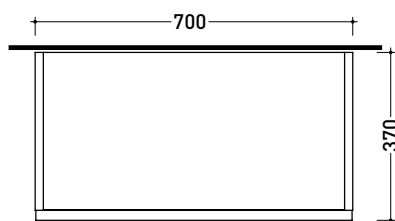

vista zenitale / zenital view

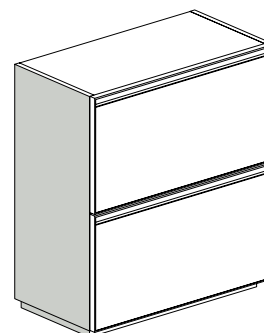

assonometria / axonometry

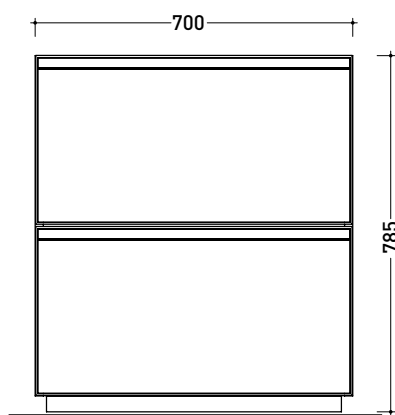

vista frontale / frontal view

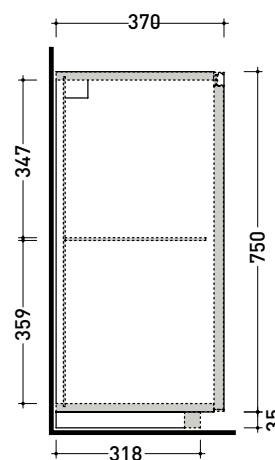

sezione longitudinale / section

dimensioni in mm



2022

## CKD163 L 85 x P 37 x H 78,5

Base a terra - 2 CASSETTI

**TOP ESCLUSO**

Complementi: Specchi linea FLAG, MADRE

Dim. Imballo

Peso **33,1 kg**

Pz. Pallet n° -

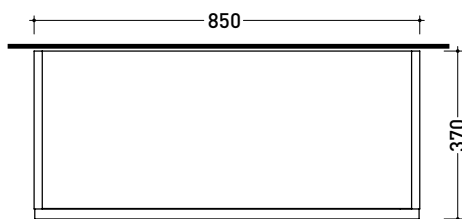

vista zenitale / zenital view

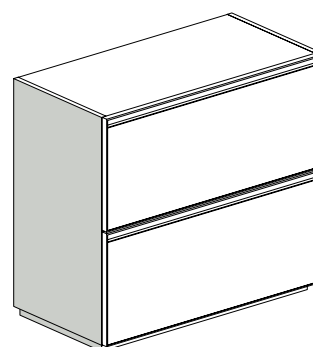

assonometria / axonometry

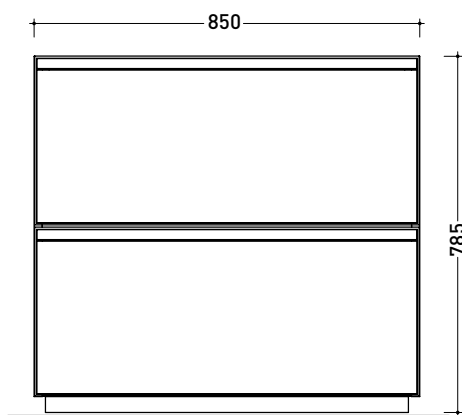

vista frontale / frontal view

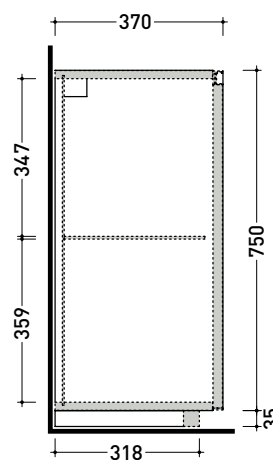

sezione longitudinale / section

dimensioni in mm

2022

## CKD400 L 25 x P 37 x H 50

Base sospesa - 1 ANTA (Specificare se dx o sx)

**TOP ESCLUSO**

Complementi: Specchi linea FLAG, MADRE

Dim. Imballo

Peso 14,3 kg

Pz. Pallet n° -

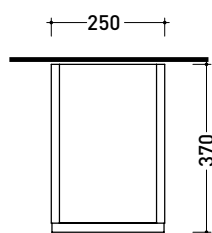

vista zenitale / zenital view

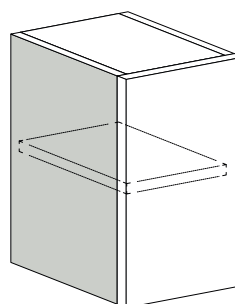

assonometria / axonometry

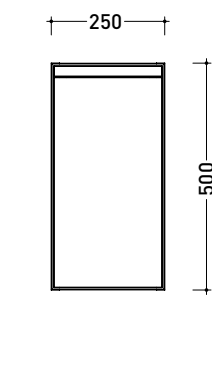

vista frontale / frontal view

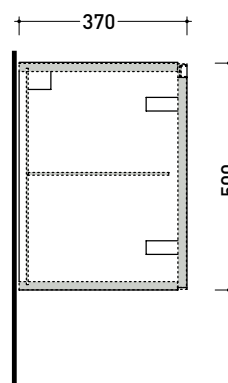

sezione longitudinale / section

dimensioni in mm

2022

## CKD406 L 35 x P 37 x H 50

Base sospesa - 1 ANTA (Specificare se dx o sx)

**TOP ESCLUSO**

Complementi: Specchi linea FLAG, MADRE

Dim. Imballo

Peso 15,6 kg

Pz. Pallet n° -

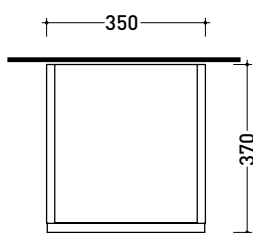

vista zenitale / zenital view

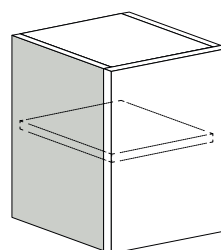

assonometria / axonometry

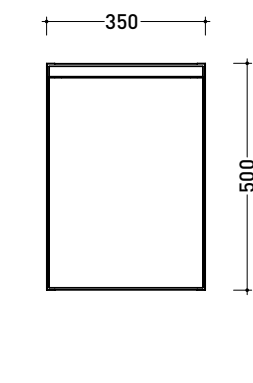

vista frontale / frontal view

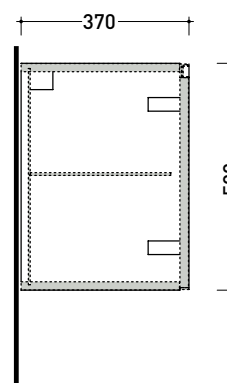

sezione longitudinale / section

dimensioni in mm

2022

## CKD412 L50 x P37 x H50

Base sospesa - 2 ANTE

**TOP ESCLUSO**

Complementi: Specchi linea FLAG, MADRE

Dim. Imballo

Peso 17,3 kg

Pz. Pallet n° -

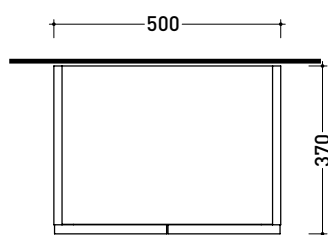

vista zenitale / zenital view

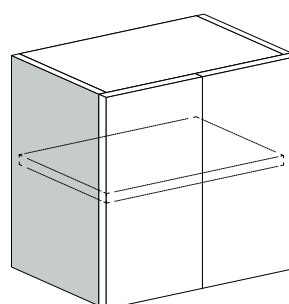

assonometria / axonometry

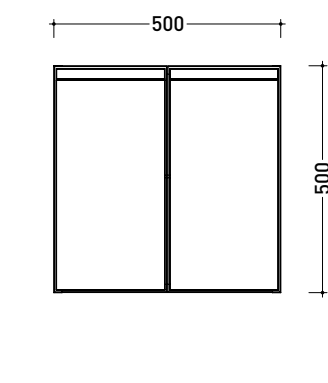

vista frontale / frontal view

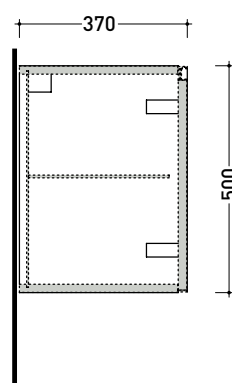

sezione longitudinale / section

dimensioni in mm

2022

## CKD420 L70 x P 37 x H 50

Base sospesa - 2 ANTE

**TOP ESCLUSO**

Complementi: Specchi linea FLAG, MADRE

Dim. Imballo

Peso **20,5 kg**

Pz. Pallet n° -

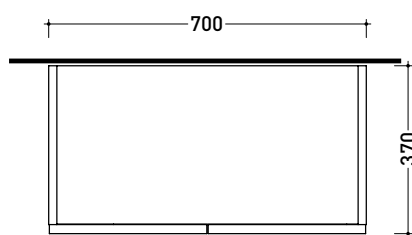

vista zenitale / zenital view

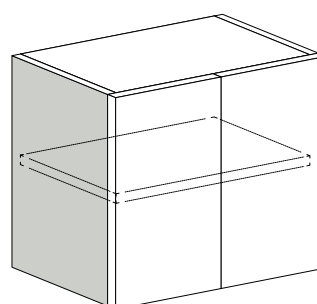

assonometria / axonometry

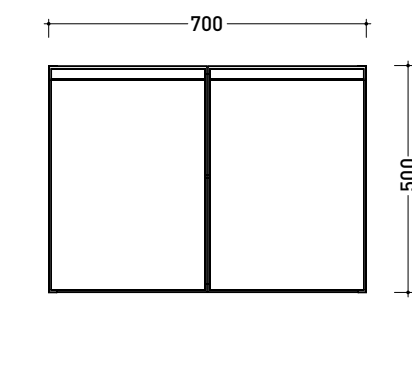

vista frontale / frontal view

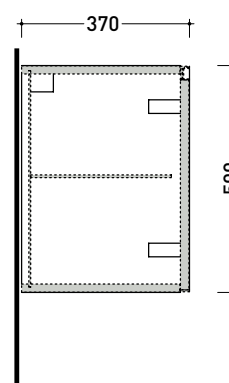

sezione longitudinale / section

dimensioni in mm

2022

## CKD496 L 85 x P 37 x H 50

Base sospesa - 2 ANTE

**TOP ESCLUSO**

Complementi: Specchi linea FLAG, MADRE

Dim. Imballo

Peso **23,7 kg**

Pz. Pallet n° -

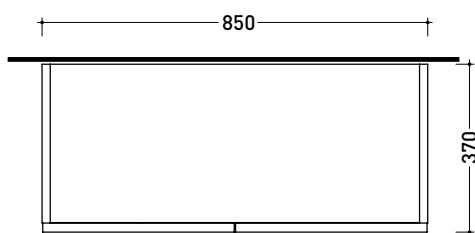

**vista zenitale / zenital view**

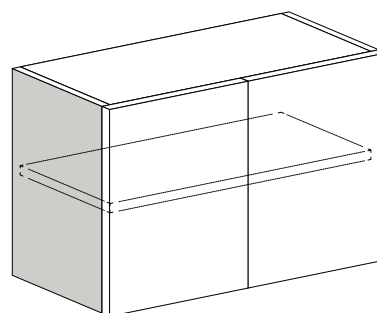

**assonometria / axonometry**

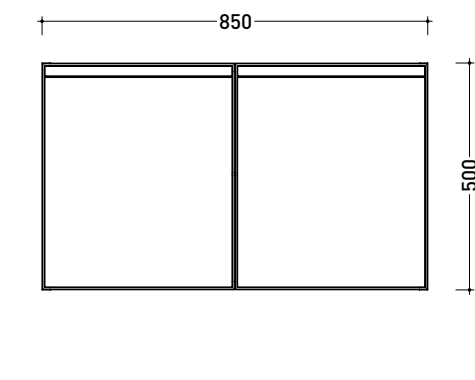

**vista frontale / frontal view**

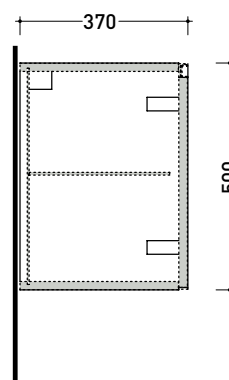

**sezione longitudinale / section**

dimensioni in mm

2022

## CKD584 L 95 x P 37 x H 50

Base sospesa - 2 ANTE

**TOP ESCLUSO**

Complementi: Specchi linea FLAG, MADRE

Dim. Imballo

Peso **24,3 kg**

Pz. Pallet n° -

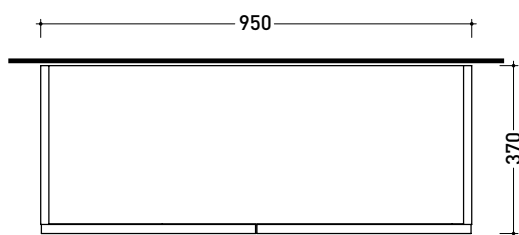

vista zenitale / zenital view

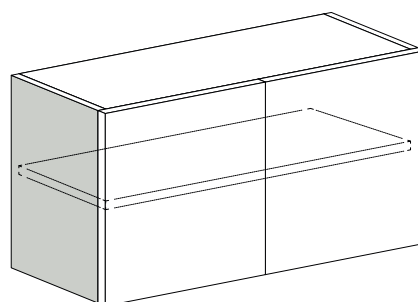

assonometria / axonometry

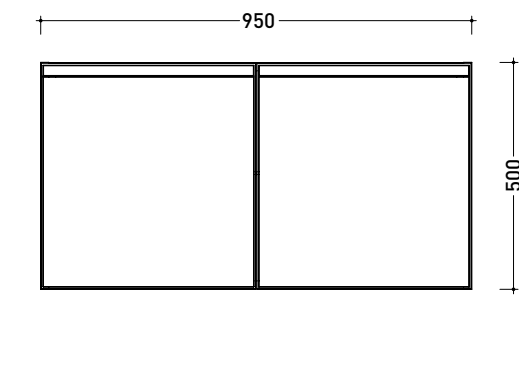

vista frontale / frontal view

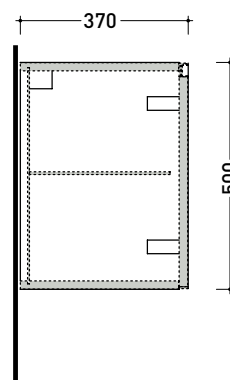

sezione longitudinale / section

dimensioni in mm

2022

## CKD460 L 35 x P 37 x H 50

Base sospesa H50 - 1 CASSETTO (+1 INTERNO)

**TOP ESCLUSO**

Complementi: Specchi linea FLAG, MADRE

Dim. Imballo

Peso 17,4 kg

Pz. Pallet n° -

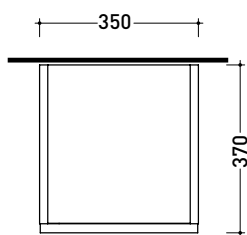

**vista zenitale** / zenital view

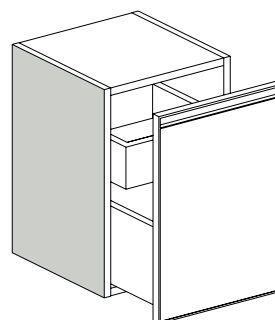

**assonometria** / axonometry

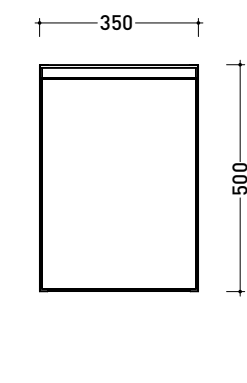

**vista frontale** / frontal view

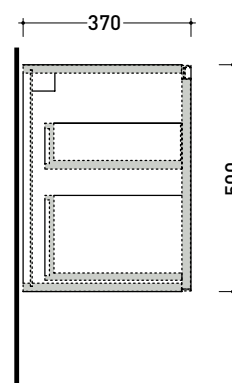

**sezione longitudinale** / section

dimensioni in mm



2022

## CKD466 L 50 x P 37 x H 50

Base sospesa H50 - 1 CASSETTO (+1 INTERNO)  
**TOP ESCLUSO**

Complementi: Specchi linea FLAG, MADRE

Dim. Imballo

Peso **20,5 kg**

Pz. Pallet n° -

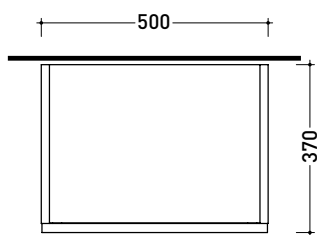
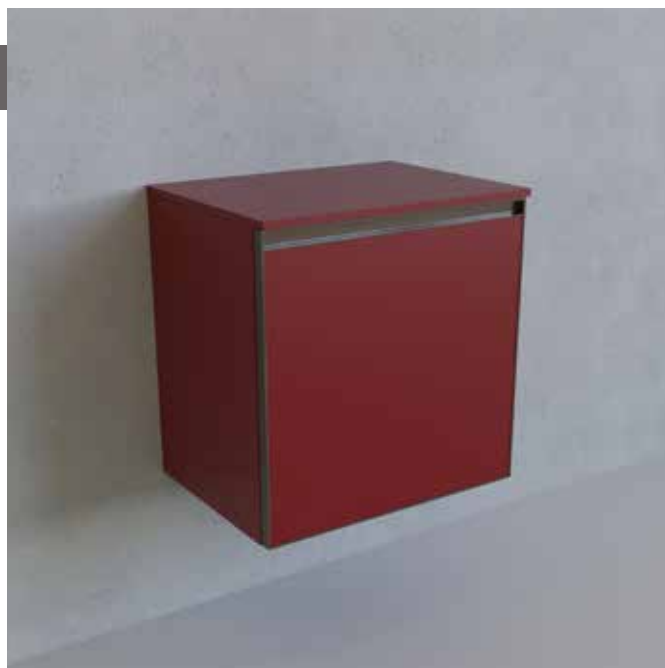

**vista zenitale / zenital view**

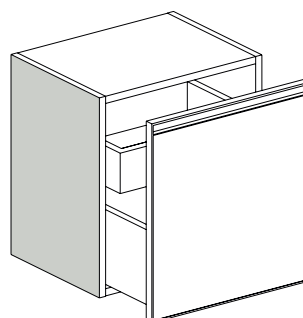

**assonometria / axonometry**

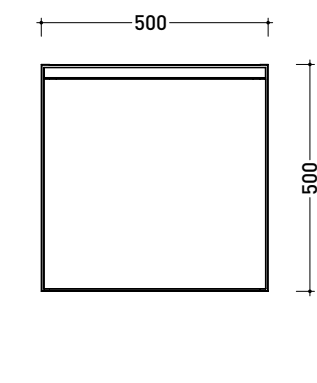

**vista frontale / frontal view**

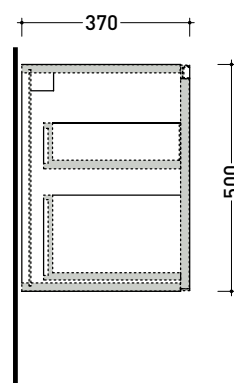

**sezione longitudinale / section**

dimensioni in mm

2022

## CKD620 L 60 x P 37 x H 50

Base sospesa H50 - 1 CASSETTO (+1 INTERNO)  
**TOP ESCLUSO**

Complementi: Specchi linea FLAG, MADRE

Dim. Imballo

Peso **22,5 kg**

Pz. Pallet n° -

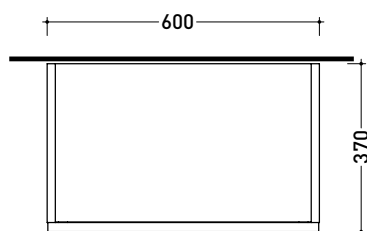

**vista zenitale / zenital view**

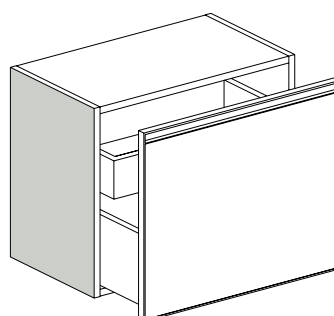

**assonometria / axonometry**

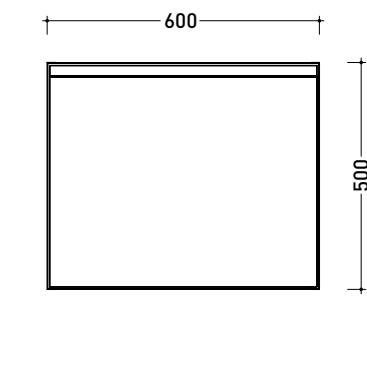

**vista frontale / frontal view**

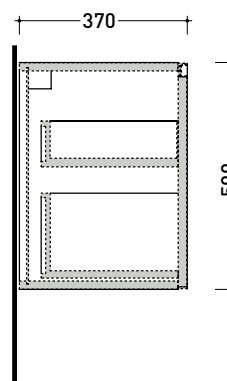

**sezione longitudinale / section**

dimensioni in mm

2022

## CKD472 L 70 x P 37 x H 50

Base sospesa H50 - 1 CASSETTO (+1 INTERNO)

**TOP ESCLUSO**

Complementi: Specchi linea FLAG, MADRE

Dim. Imballo

Peso **24,4 kg**

Pz. Pallet n° -

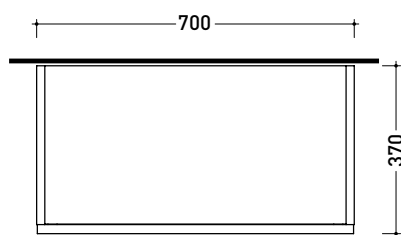

**vista zenitale / zenital view**

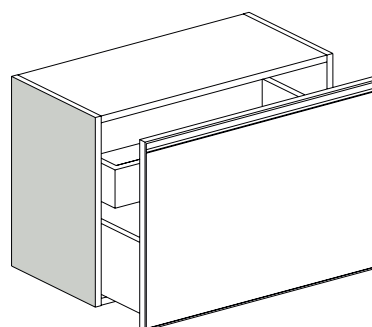

**assonometria / axonometry**

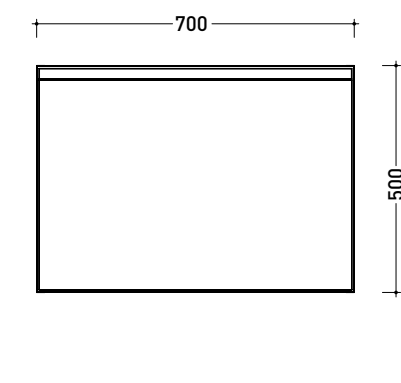

**vista frontale / frontal view**

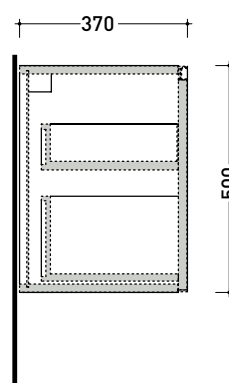

**sezione longitudinale / section**

dimensioni in mm

2022

## CKD486 L 85 x P 37 x H 50

Base sospesa H50 - 1 CASSETTO (+1 INTERNO)  
**TOP ESCLUSO**

Complementi: Specchi linea FLAG, MADRE

Dim. Imballo

Peso **21,6 kg**

Pz. Pallet n° -

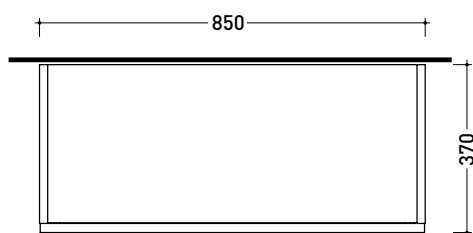

**vista zenitale / zenital view**

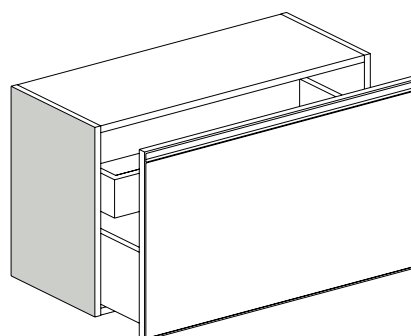

**assonometria / axonometry**

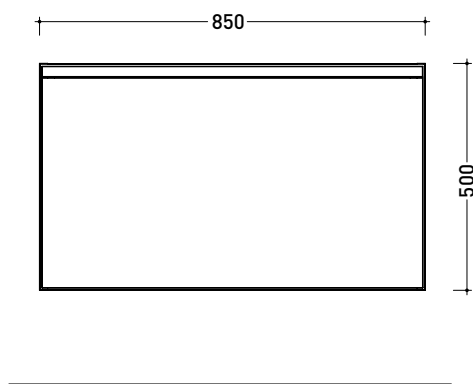

**vista frontale / frontal view**

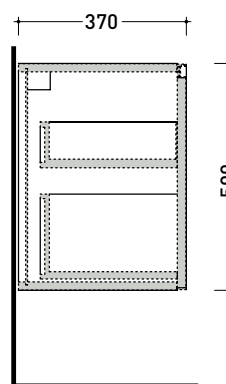

**sezione longitudinale / section**

dimensioni in mm

2022

## CKD489 L 95 x P 37 x H 50

Base sospesa H50 - 1 CASSETTO (+1 INTERNO)  
**TOP ESCLUSO**

Complementi: Specchi linea FLAG, MADRE

Dim. Imballo

Peso **28,3 kg**

Pz. Pallet n° -

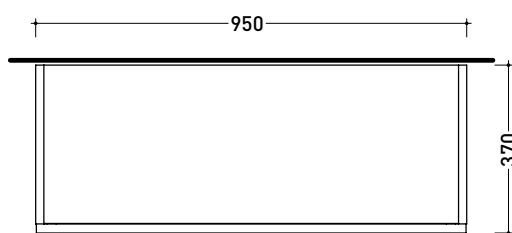

**vista zenitale** / zenital view

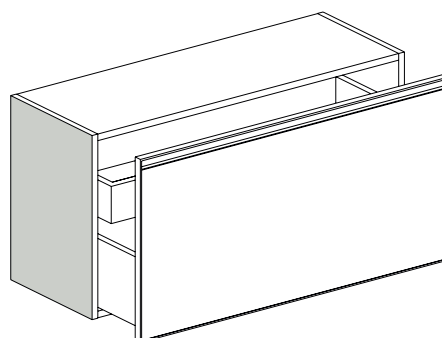

**assonometria** / axonometry

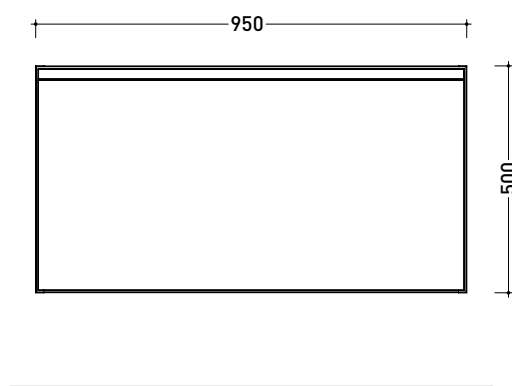

**vista frontale** / frontal view

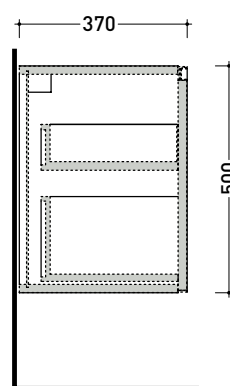

**sezione longitudinale** / section

dimensioni in mm

2022

## CKDE01 L 105 x P 37 x H 50

Base sospesa H50 - 1 CASSETTO (+1 INTERNO)  
**TOP ESCLUSO**

Complementi: Specchi linea FLAG, MADRE

Dim. Imballo

Peso 17,8 kg

Pz. Pallet n° -

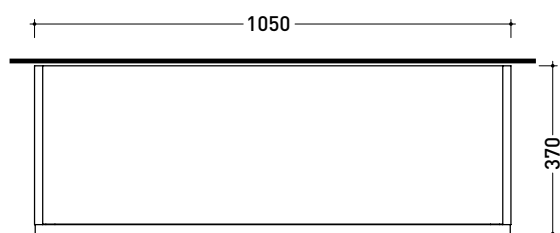

**vista zenitale / zenital view**

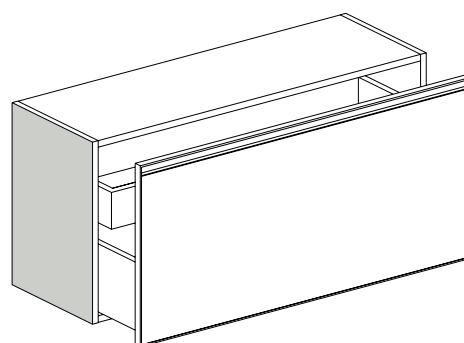

**assonometria / axonometry**

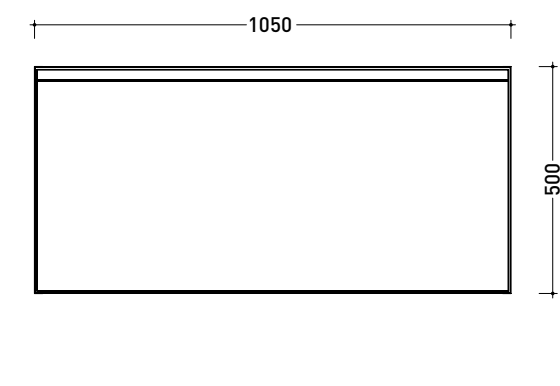

**vista frontale / frontal view**

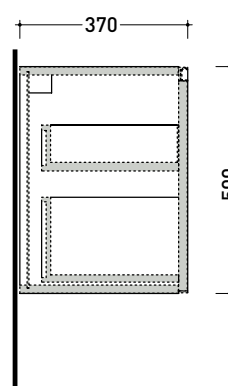

**sezione longitudinale / section**

dimensioni in mm

2022

## CKDE07 L 120 x P 37 x H 50

Base sospesa H50 - 1 CASSETTO (+1 INTERNO)  
**TOP ESCLUSO**

Complementi: Specchi linea FLAG, MADRE

Dim. Imballo

Peso **26,3 kg**

Pz. Pallet n° -

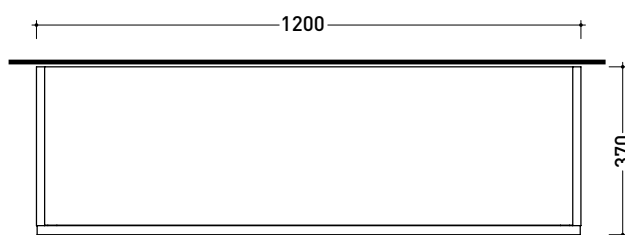

**vista zenitale / zenital view**

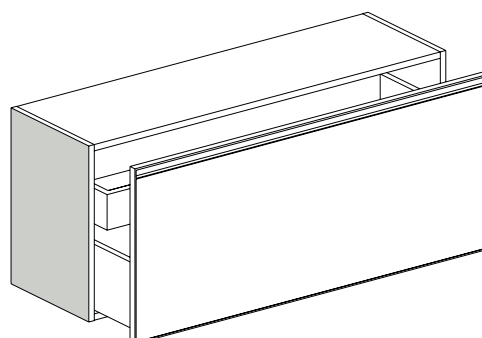

**assonometria / axonometry**

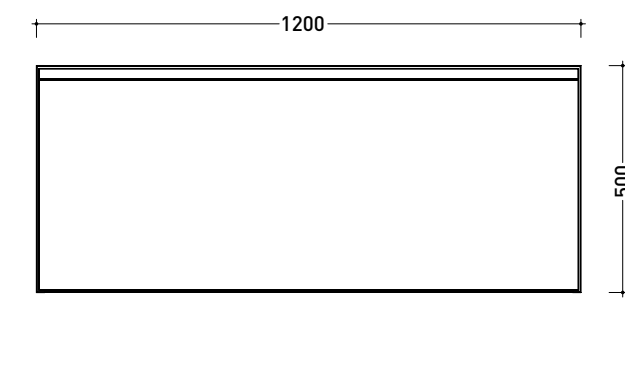

**vista frontale / frontal view**

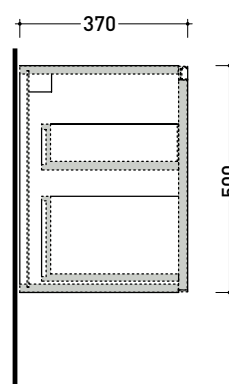

**sezione longitudinale / section**

dimensioni in mm

2022

## CKD404 L 25 x P 37 x H 50

Base sospesa H50 - 2 CASSETTI

**TOP ESCLUSO**

Complementi: Specchi linea FLAG, MADRE

Dim. Imballo

Peso 15,7 kg

Pz. Pallet n° -

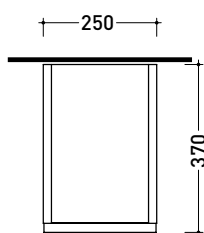

vista zenitale / zenital view

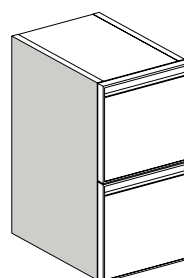

assonometria / axonometry

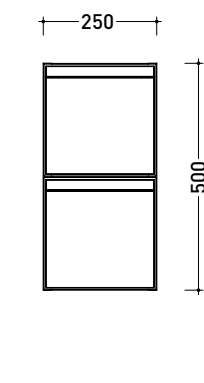

vista frontale / frontal view

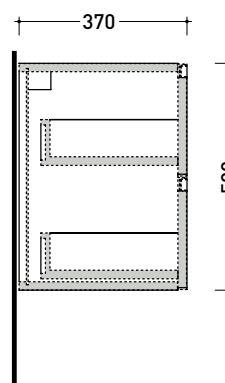

sezione longitudinale / section

dimensioni in mm



2022

## CKD410 L 35 x P 37 x H 50

Base sospesa H50 - 2 CASSETTI

**TOP ESCLUSO**

Complementi: Specchi linea FLAG, MADRE

Dim. Imballo

Peso 17,4 kg

Pz. Pallet n° -

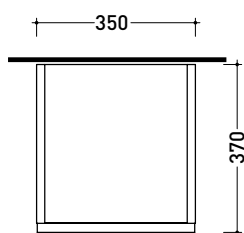

vista zenitale / zenital view

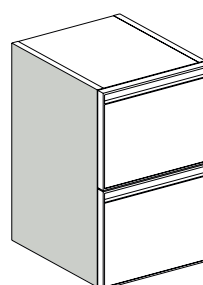

assonometria / axonometry

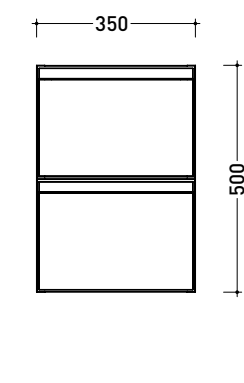

vista frontale / frontal view

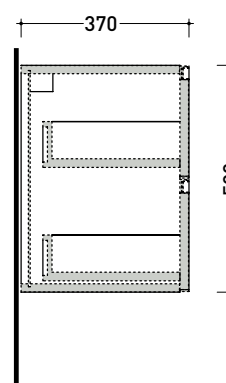

sezione longitudinale / section

dimensioni in mm

2022

## CKD416 L 50 x P 37 x H 50

Base sospesa H50 - 2 CASSETTI

**TOP ESCLUSO**

Complementi: Specchi linea FLAG, MADRE

Dim. Imballo

Peso 19,9 kg

Pz. Pallet n° -

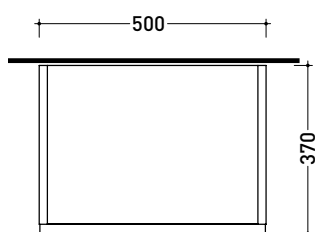

vista zenitale / zenital view

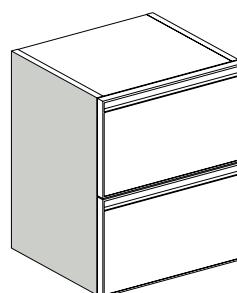

assonometria / axonometry

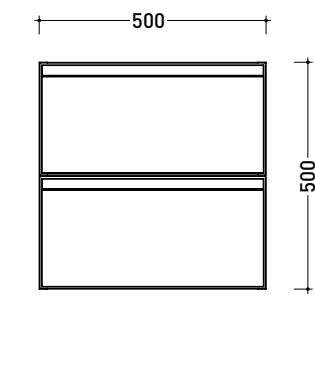

vista frontale / frontal view

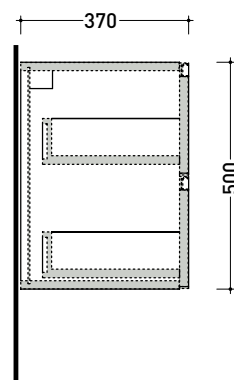

sezione longitudinale / section

dimensioni in mm

2022

## CKD424 L 70 x P 37 x H 50

Base sospesa H50 - 2 CASSETTI

**TOP ESCLUSO**

Complementi: Specchi linea FLAG, MADRE

Dim. Imballo

Peso **23,3kg**

Pz. Pallet n° -

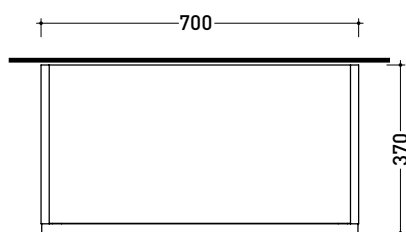

vista zenitale / zenital view

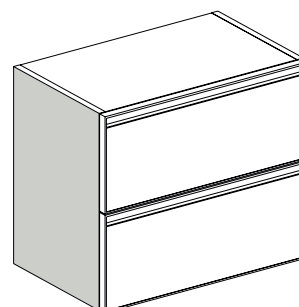

assonometria / axonometry

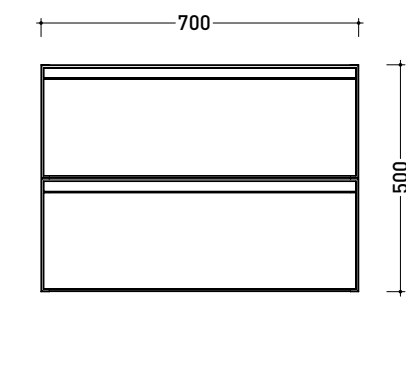

vista frontale / frontal view

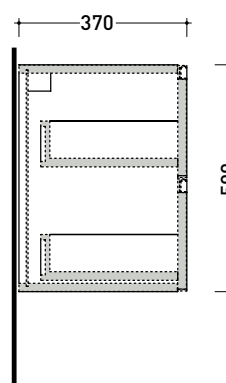

sezione longitudinale / section

dimensioni in mm

2022

## CKD428 L 85 x P 37 x H 50

Base sospesa H50 - 2 CASSETTI

**TOP ESCLUSO**

Complementi: Specchi linea FLAG, MADRE

Dim. Imballo

Peso **25,8 kg**

Pz. Pallet n° -

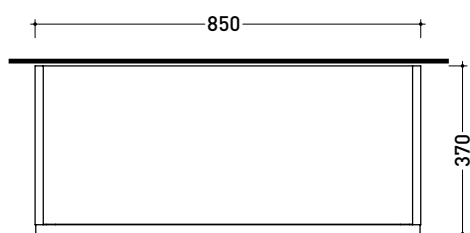

**vista zenitale / zenital view**

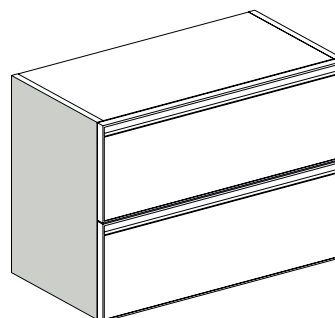

**assonometria / axonometry**

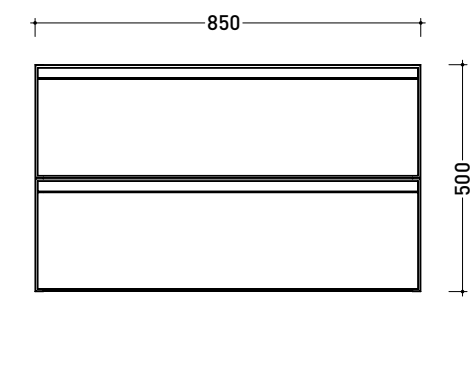

**vista frontale / frontal view**

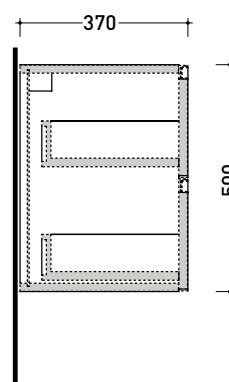

**sezione longitudinale / section**

dimensioni in mm

2022

## CKD432 L 95 x P 37 x H 50

Base sospesa H50 - 2 CASSETTI

**TOP ESCLUSO**

Complementi: Specchi linea FLAG, MADRE

Dim. Imballo

Peso **27,5 kg**

Pz. Pallet n° -

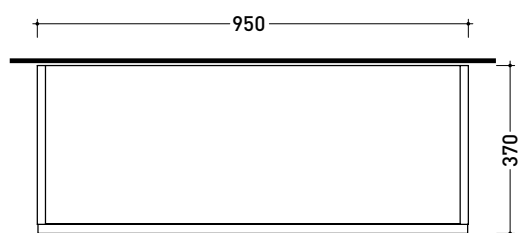

vista zenitale / zenital view

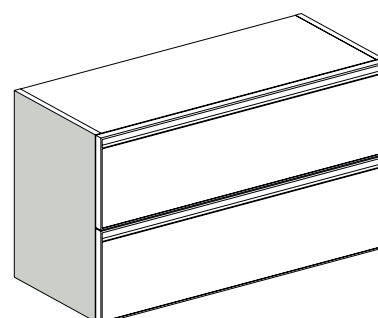

assonometria / axonometry

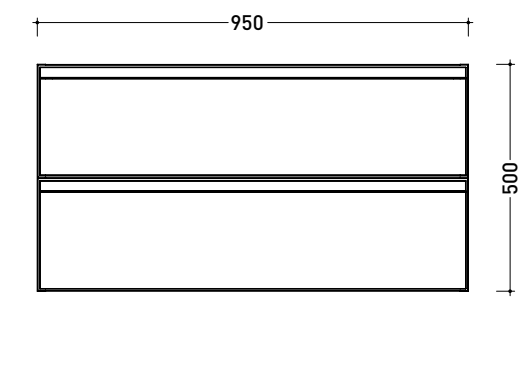

vista frontale / frontal view

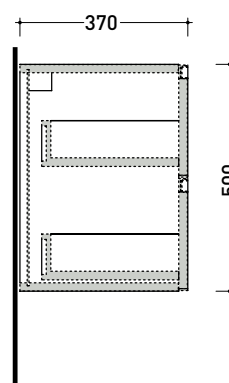

sezione longitudinale / section

dimensioni in mm

2022

## CKDE04 L105 x P 37 x H 50

Base sospesa H50 - 2 CASSETTI

**TOP ESCLUSO**

Complementi: Specchi linea FLAG, MADRE

Dim. Imballo

Peso 17,8 kg

Pz. Pallet n° -

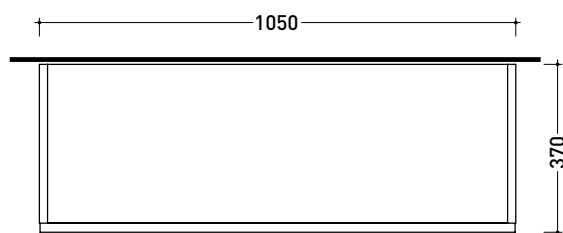

vista zenitale / zenital view

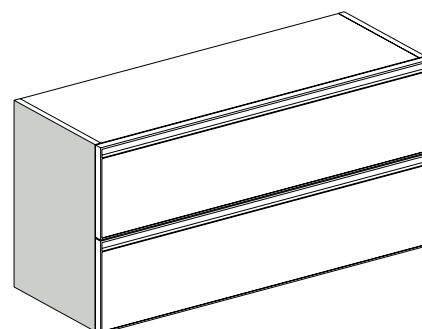

assonometria / axonometry

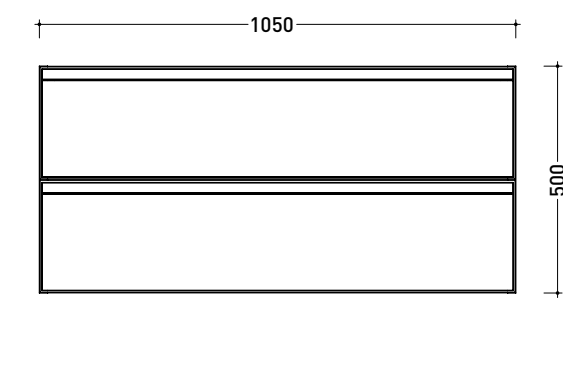

vista frontale / frontal view

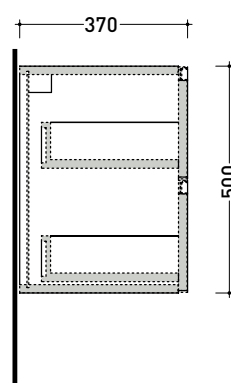

sezione longitudinale / section

dimensioni in mm

2022

## CKDE10 L 120 x P 37 x H 50

Base sospesa H50 - 2 CASSETTI

**TOP ESCLUSO**

Complementi: Specchi linea FLAG, MADRE

Dim. Imballo

Peso **26,2 kg**

Pz. Pallet n° -

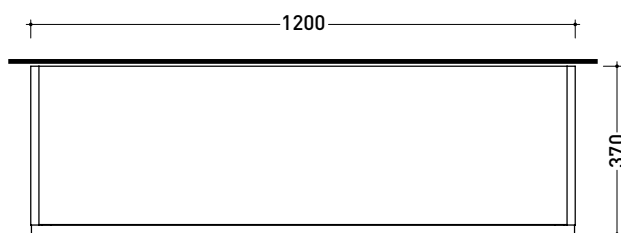

vista zenitale / zenital view

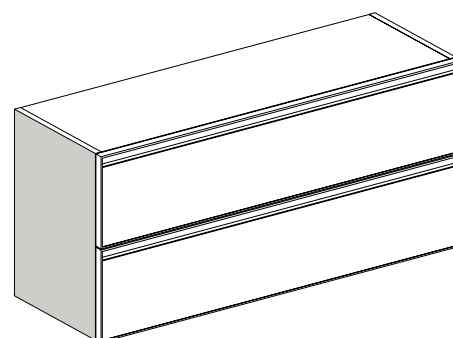

assonometria / axonometry

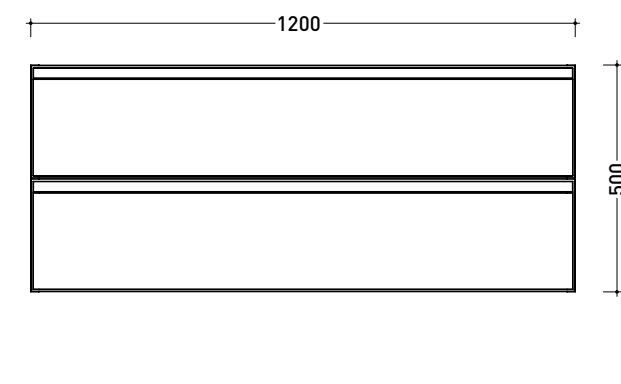

vista frontale / frontal view

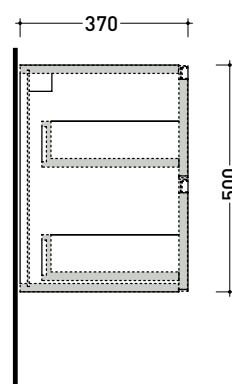

sezione longitudinale / section

dimensioni in mm

2022

## CKPR38 L 25 a max 270 x P 38 x H 1,2

Piano di copertura in legno da cm 25 a 270  
per BASI prof. 37 cm

### ATTENZIONE:

Il piano di copertura va sempre previsto e va ordinato separatamente.



CE

vista zenitale / zenital view

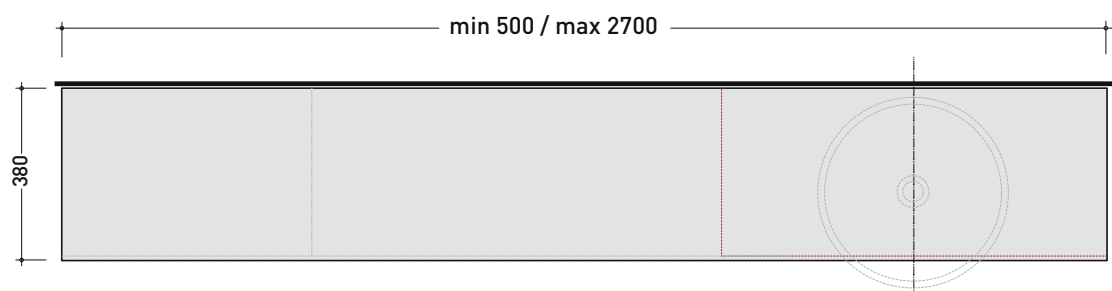

vista frontale / frontal view

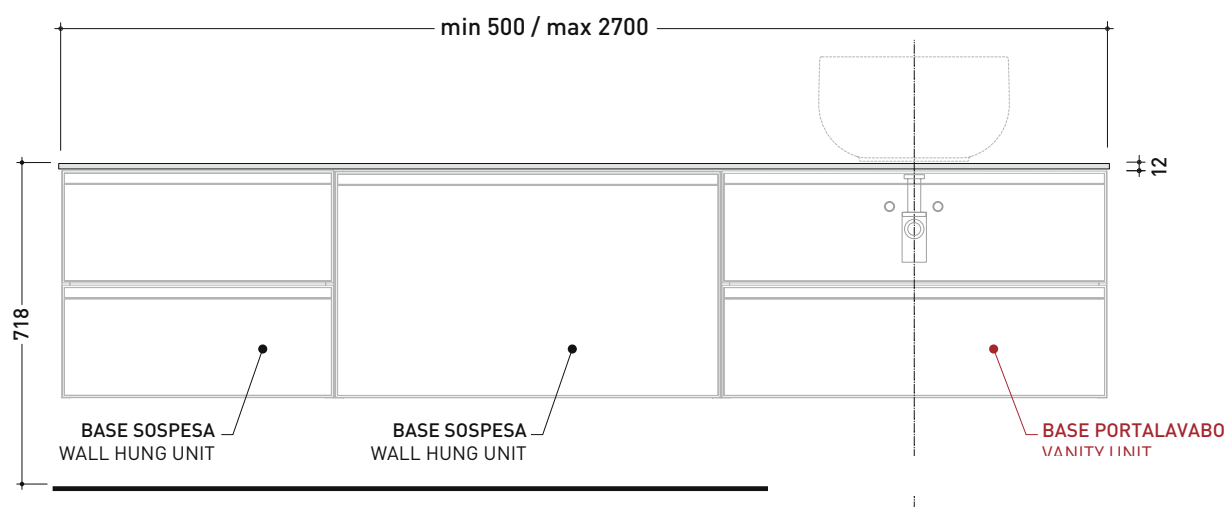

dimensioni in mm



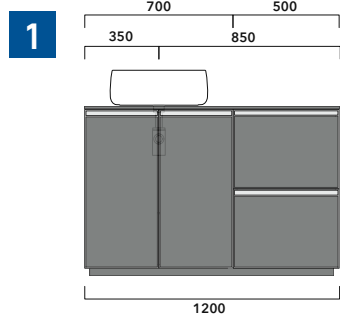

**1** I profondità cm 37:  
n.1 CKD909 + n.1 CKD151 + CKPR38 cm 120

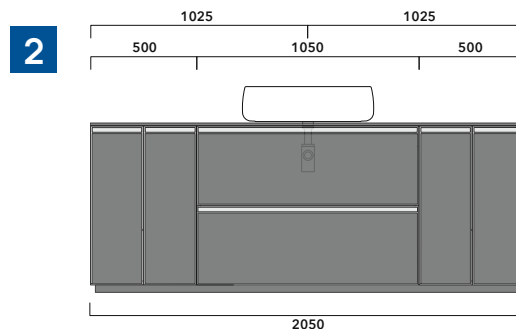

**2** I profondità cm 37:  
n.2 CKD108 + n.1 CKD753 + CKPR38 cm 205

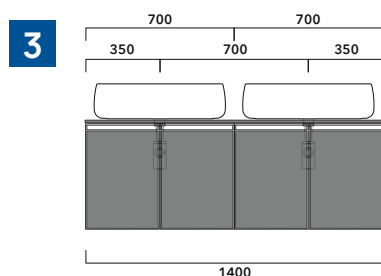

**3** I profondità cm 37:  
n.2 CKD802 + CKPR38 cm 140

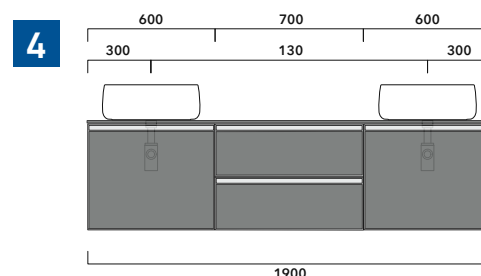

**4** I profondità cm 37:  
n.1 CKD800 + n. 1 CKD424 + CKPR38 cm 190

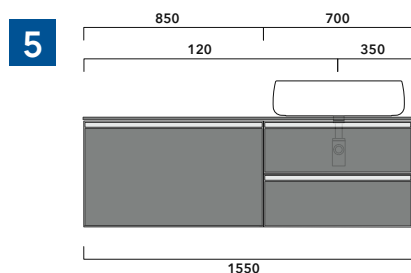

**5** I profondità cm 37:  
n.1 CKD486 + n.1 CKD808 + CKPR38 cm 155

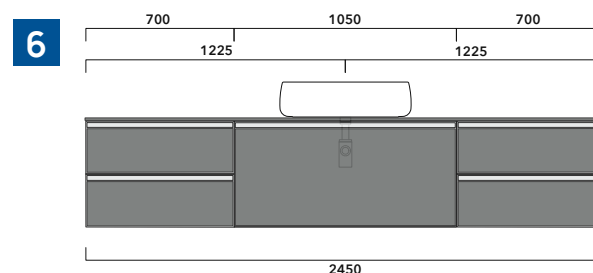

**6** I profondità cm 37:  
n.2 CKD424 + n.1 CKD892 + CKPR38 cm 245

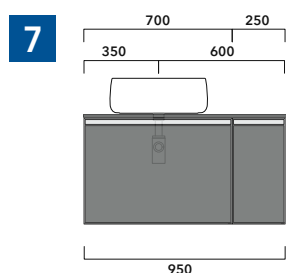

**7** I profondità cm 37:  
n.1 CKD875 + n. 1 CKD400 + CKPR38 cm 95

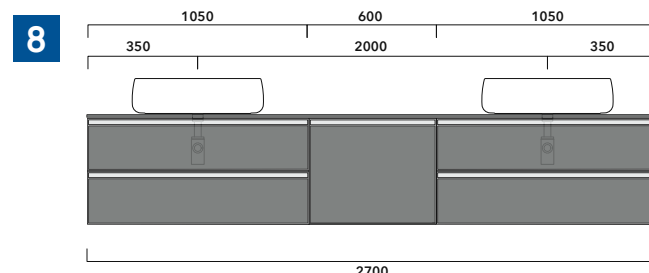

**8** I profondità cm 37:  
n.2 CKD838 + n. 1 CKD620 + CKPR38 cm 270

# ➔FLAMINIA. MODULO PER LA REALIZZAZIONE DELLE COMPOSIZIONI MOBILI CUBIKA CUSTOMIZED COMPOSITION FORM FOR CUBIKA UNITS



**E' obbligatorio fotocopiare questa pagina, compilarla con cura e allegarla all'ordine.**  
It is compulsory to photocopy this page, carefully fill in and attach to the order.

## »1 DETTAGLI ORDINE / ORDER DETAILS

ordinante - buyer

cliente - client

ordine - order n:

data - date:

ref.:

annotazioni - notes

## »2 PROFONDITÀ MOBILE / UNIT DEPTH

É importante consultare il listino prezzi / It's important to consult price list

☐ CM 37

☐ CM 50

## »3 DISEGNO / DRAWING

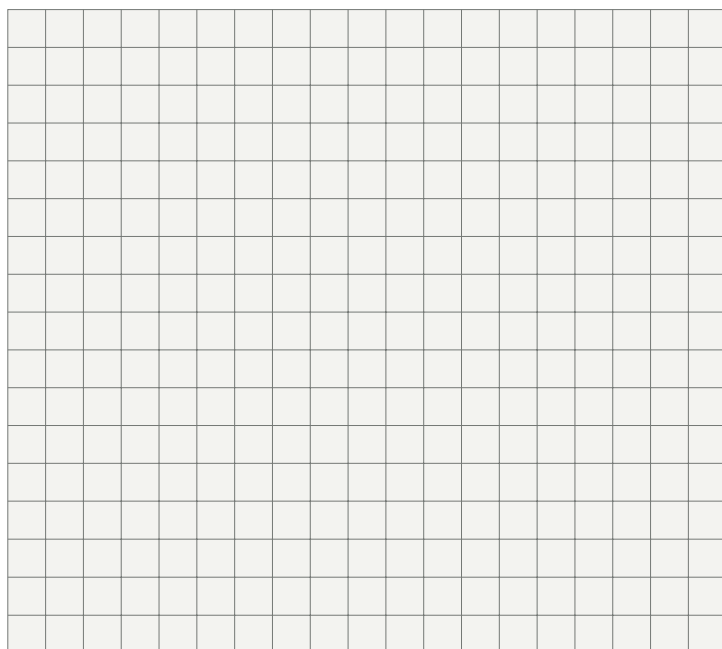

## »4 ELENCO ARTICOLI / ARTICLE LIST

É importante consultare il listino prezzi  
It's important to consult price list

n. art. dim.

n. art. dim.

n. art. dim.

n. art. dim.

n. art. dim.

n. art. dim.

n. art. dim.

**IMPORTANTE:** per il mobile con una sola anta  
specificare se è cerniera sinistra o destra  
**IMPORTANT:** for cabinet with one door specify  
whether it is left or right hinge

## »5 LAVABO DA APPOGGIO / COUTERTOP BASIN

☐ FLAMINIA lavabo/basin art. \_\_\_\_\_

☐ NO FLAMINIA lavabo/basin  
(allegare scheda tecnica / enclose a technical drawing)

## »6 FINITURA TOP / FINISH TOP

essenze legno / wood:

GRES:

legno laccato opaco / mat lacquered wood:

☐ EUCALIPTO

☐ FOKOS SALE

☐ BIANCO

☐ TAUPE

☐ BORDEAUX

☐ NOCE GRECA

☐ FOKOS TERRA

☐ GREY

☐ CIPRIA

☐ VERDE PALUDE

☐ ROVERE NAT. GRECA

☐ JUTA

☐ ROSA VINTAGE

## »6 SCELTA FINITURA / FINISH SELECTION

essenze legno / wood:

GRES:

legno laccato opaco / mat lacquered wood:

☐ EUCALIPTO

☐ FOKOS SALE

☐ BIANCO

☐ TAUPE

☐ BORDEAUX

☐ NOCE GRECA

☐ FOKOS TERRA

☐ GREY

☐ CIPRIA

☐ VERDE PALUDE

☐ ROVERE NAT. GRECA

☐ JUTA

☐ ROSA VINTAGE