

AP5025DX AppLight 5025

Wall-hung basin 50x25 cm with RIGHT tap ledge

• without overflow • arranged for single-tap hole

Complements: **Chromed towel holder** (PMW60)
Line taps basin: ONE - NOKÉ - SI - FOLD - X1 - STIL
Line accessories: TWO - HOOP - FOLD

Technical accessories: **Chrome siphon** (SIFL/CR) - **Telescopic chrome siphon** (SIFL066)
Chrome waste with automatic integrated overflow (PLTPCR)
Waste with automatic integrated overflow and ceramic cover (PLTPCE)
Stop & Go drain (PLSG)
CERAMIC Stop & Go drain (PLCE)
Two piece set chrome tap filters (RF026)
Fixing kit for wall (9002)

Package dim.

Weight 11 kg

Pz. Pallet n° 40

CE UNI EN 14688 - CL00 Dop-No14688

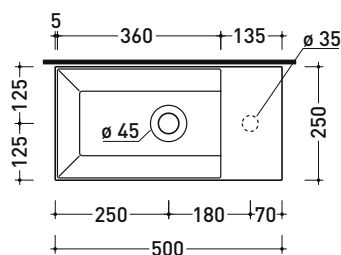

vista zenitale / zenital view

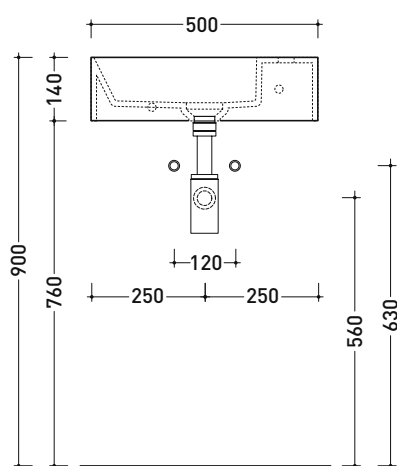

vista frontale / frontal view

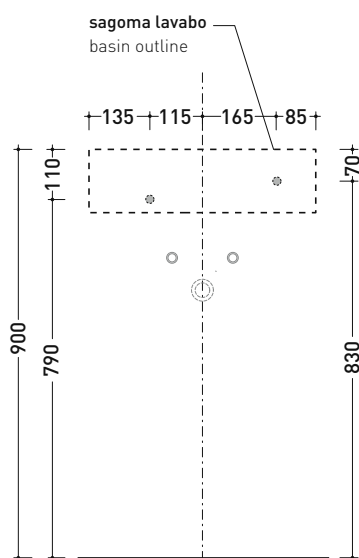

vista frontale fissaggio lavabo
fixing basin frontal view

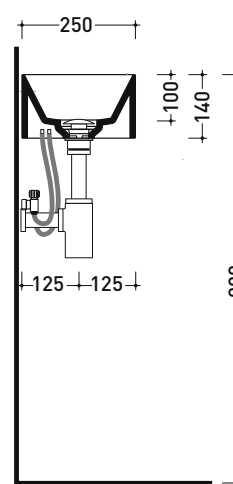

sezione longitudinale / section