

## AP118G

Wall hung wc with **goclean®** system (fixing kit included art. 9008)

Complements: **Thermosetting wrapping seat&cover** (QKCW02)  
**Soft-closing thermosetting wrapping seat&cover** (QKCW03)  
**SLIM thermosetting seat&cover** (QKCW04)  
**SLIM soft-closing thermosetting seat&cover** (QKCW05)  
**gocare electronic multifunction coverseat** (FL7235 - FL7035R)  
**Line accessories: TWO - HOOP - NOKÈ - FOLD**

Technical accessories: **Universal fixing bracket for wall hung wc/bidet** (41/P)

Package dim. | Weight **22,5 kg** | Pz. Pallet n° **18**



UNI EN 997

Dop-No997

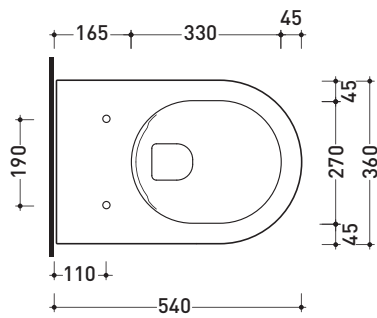

vista zenitale / zenital view

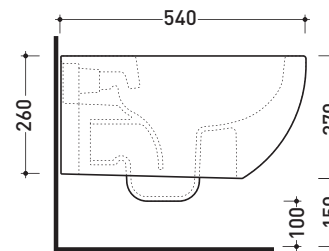

vista laterale / lateral view

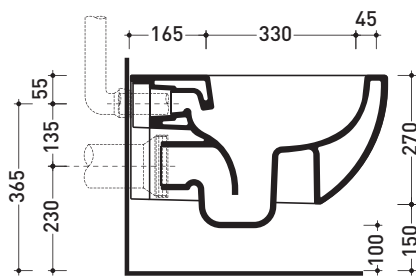

sezione longitudinale / section



art. 9008  
 kit di fissaggio  
 Fischer (in dotazione)  
 Fischer fixing kit  
 (included in the box)

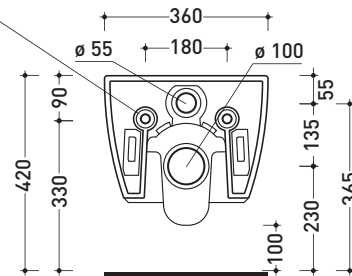

vista retro / back view

sizes in mm

Please consider a 2% tolerance on indicated measurements

CERAMIC: glossy finish



matt finish

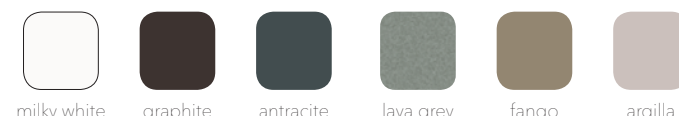

**FLAMINIA does not recommend combining this toilet model with rapid-flow/flushometer systems or traditional high tanks**